

Social Safeguards Compliance Report

May 2015

IND: Rural Connectivity Investment Program

RCTRC and RRNMU Buildings in Assam, Chhattisgarh, Madhya Pradesh, Odisha and West Bengal under Project 1 (Loan 2881-IND) and Project 3

Prepared by Ministry of Rural Development, Government of India for the Asian Development Bank.

CURRENCY EQUIVALENTS

(as of 9 February 2015)

| | | |
|---------------|---|---------------------|
| Currency unit | – | Indian Rupees (INR) |
| INR1.00 | = | \$ 0.02 |
| \$1.00 | = | INR 62.19 |

ABBREVIATIONS

| | | |
|--------|---|--|
| ADB | - | Asian Development Bank |
| APs | - | Affected Persons |
| ARRDA | - | Assam Rural Road Development Agency |
| ARR&TI | - | Assam Road Research & Training Institute |
| CEO | - | Chief Executive Officer |
| CGRRDA | - | Chhattisgarh Rural Road Development Authority |
| CPF | - | Community Participation Framework |
| DC | - | Deputy Commissioner |
| EA | - | Executing Agency |
| FFA | - | Framework Financing Agreement |
| GOI | - | Government of India |
| GP | - | Gram Panchayat |
| GRC | - | Grievances Redressal Committee |
| IA | - | Implementing Agency |
| MFF | - | Multitranches Financing Facility |
| MORD | - | Ministry of Rural Development |
| MOU | - | Memorandum of Understanding |
| MPRRDA | - | Madhya Pradesh Rural Road Development Authority |
| NRDA | - | Naya Raipur Development Authority |
| NRRDA | - | National Rural Road Development Agency |
| OSRRA | - | Odisha State Rural Road Agency |
| PIU | - | Project Implementation Unit |
| PIC | - | Project Implementation Consultants |
| PFR | - | Periodic Finance Request |
| PMGSY | - | Pradhan Mantri Gram Sadak Yojana |
| PRDD | - | Panchayat and Rural Development Deptt |
| PWD | - | Public Works Department |
| RCIP | - | Rural Connectivity Investment Programme |
| RCTRC | - | Rural Connectivity Training And Research Centers |
| RD | - | Rural Development |
| RES | - | Rural Engineering Services |
| RRL | - | Road Research Laboratory |
| RRNMU | - | Rural Road Network Management Units |
| RRSIIP | - | Rural Road Sector II Project |
| SIRD | - | State Institute of Rural Development |
| SRRDA | - | State Rural Road Development Agency |
| TA | - | Technical Assistance |
| TOR | - | Terms of Reference |
| TSC | - | Technical Support Consultants |
| WALMI | - | Water and Land Management Institute |
| WBSRDA | - | West Bengal State Rural Development Agency |

NOTE

In this report, \$ refers to US Dollars

This due diligence report is a document of the borrower. The views expressed herein do not necessarily represent those of ADB's Board of Directors, Management, or staff, and may be preliminary in nature. Your attention is directed to the "terms of use" section of this website.

In preparing any country program, strategy, financing any project, or by making any designation of or reference to a particular territory or geographis area in this document, the Asian Development Bank does not intend to make any judgments as to the legal or other status of any territory or area.

CONTENTS

| | |
|--|-----------|
| I. RURAL CONNECTIVITY INVESTMENT PROGRAM: PROJECT 3 – ASSAM | 1 |
| A. Context and Purpose of the Report | 1 |
| B. Status of RRNMUs and RCTRC in Assam | 1 |
| C. Social Safeguards in the Project | 2 |
| D. Approach and Methodology for Assessing Social Safeguards Compliance during preparation of the subprojects | 3 |
| E. Findings | 4 |
| F. Conclusion | 6 |
| Appendix 1: Social Safeguards Checklist for RCTRC, Guwahati, Assam | 7 |
| Appendix 2: Social Safeguards Checklist for Due Diligence Review of the RRNMU, Tezpur, Assam | 11 |
| II. RURAL CONNECTIVITY INVESTMENT PROGRAM: PROJECT 3 –CHHATTISGARH | 19 |
| A. Context and Purpose of the Report | 19 |
| B. Status of RRNMUs and RCTRC in Chhattisgarh | 19 |
| C. Social Safeguards in the Project | 20 |
| D. Approach and Methodology for Assessing Social Safeguards Compliance during preparation of the subprojects | 22 |
| E. Findings | 22 |
| F. Conclusion | 24 |
| Appendix 1: Social Safeguards Checklist for due diligence review of the Pilot for RCTRC In Raipur, CG | 25 |
| Appendix 2: Social Safeguards Checklist for Pilot RRNMU In Naya Raipur, CG | 31 |
| III. RURAL CONNECTIVITY INVESTMENT PROGRAM - PROJECT 3: MADHYA PRADESH | 39 |
| A. Context and Purpose of the Report | 39 |
| B. Status of RRNMUs and RCTRC in Madhya Pradesh | 39 |
| C. Social Safeguards in the Project | 40 |
| D. Approach and Methodology for Assessing Social Safeguards Compliance during preparation of the subprojects | 42 |
| E. Findings | 42 |
| F. Conclusion | 44 |
| Appendix 1: Social Safeguards Checklist of RCTRC in Bhopal, MP | 45 |
| Appendix 2: Social Safeguards Checklist for Pilot RRNMU at Jabalpur, MP | 50 |
| IV. RURAL CONNECTIVITY INVESTMENT PROGRAM – PROJECT 3 ODISHA | 57 |
| A. Context and Purpose of the Report | 57 |
| B. Status of RRNMUs and RCTRC in Odisha | 57 |
| C. Social Safeguards in the Project | 58 |
| D. Approach and Methodology for Assessing Social Safeguards Compliance during preparation of the subprojects | 59 |
| E. Findings | 60 |
| F. Conclusion | 62 |
| Appendix 1: Social Safeguards Checklist for RCTRC at Bhubaneswar, Odisha | 63 |
| Appendix 2: Social Safeguards Checklist for Pilot RRNMU at Angul, Odisha | 69 |
| V. RURAL CONNECTIVITY INVESTMENT PROGRAM– PROJECT 3: WEST BENGAL | 75 |
| A. Context and Purpose of the Report | 75 |
| B. Status of RRNMUs and RCTRC in West Bengal | 75 |
| C. Social Safeguards in the Project | 76 |
| D. Approach and Methodology for Assessing Social Safeguards Compliance during preparation of the subprojects | 77 |
| E. Findings | 78 |

| | |
|---|----|
| F. Conclusion | 79 |
| Appendix 1: Social Safeguards Checklist for RCTRC at Kalyani, West Bengal | 81 |
| Appendix 2: Social Safeguards Checklist for Pilot RRNMU at Barasat, West Bengal | 85 |

I. RURAL CONNECTIVITY INVESTMENT PROGRAM: PROJECT 3 – ASSAM SOCIAL SAFEGUARDS COMPLIANCE – RRNMUs and RCTRC

A. Context and Purpose of the Report

1. The Government of India (GOI) launched “The Pradhan Mantri Gram Sadak Yojna (PMGSY) in 2000, with the objective to provide all-weather road connectivity to all rural habitations with a population of more than 500 persons in plains and 250 persons in hill states. This program is being implemented through the National Rural Road Development Authority (NRRDA) under the Ministry of Rural Development (MORD) at central level and through the State Rural Road Development Authority/Agencies (SRRDA) at state level.

2. The Rural Connectivity Investment Program (RCIP) supports PMGSY through a multi-Project Financing Facility (MFF) that will construct or upgrade to all-weather standards 3,998 rural roads equivalent to 13,884 km, and connecting 5,238 habitations in the states of Assam, Chhattisgarh, Odisha, Madhya Pradesh and West Bengal (RCIP states). Investments in rural roads will improve connectivity, cut transport costs, and provide enabling infrastructure to areas currently with poor access to markets and urban towns, and thus contribute to growth and equity in the country’s largest sector.

3. RCIP is divided into three separate projects. Project 1 and Project 2 of US\$252 million, and \$US 275 million respectively, were approved in 2013 and are ongoing. Project 3 is expected to be approved at the end of 2015 with an estimated cost of USD 518.30 million.

4. Under RCIP Project 1 (Loan 2881-IND), each State is to establish one pilot RRNMU. Later during RCIP Project 3 (Tranche 3) approximately five additional RRNMUs (30 RRNMUs in total) are planned to be created. The RRNMUs shall be created based on the existing PIUs for rural roads and shall have staffing, equipment, and facilities adequate to provide effective management of the rural road network. The States shall ensure full RRNMU staffing and budget adequate for the full implementation of RRNMU tasks. The States shall prepare the design of RRNMU facilities. Similarly, under RCIP Project 1 (Loan 2881-IND) each State is to establish one RCTRC with the main objective to (i) conduct systematic training of engineers involved in the management of the rural road network, technicians, site supervisors, concerned staff of Panchayati Raj institutions, design consultants and contractors, and (ii) support a sustainable practice-oriented research on rural roads. The RCTRCs shall have staffing, equipment, and facilities adequate to provide high-quality and large scale training, both in house and with the use of external resource persons. Each State shall ensure full RCTRC staffing and budget adequate for the full implementation of RCTRC tasks. Like the RRNMUs, the States shall prepare the design of RCTRC facilities. The Assam Rural Road Development Agency (ARRDA) is the implementing agency (IA) for the ADB funded subprojects in the state.

5. The Government is now planning to submit to ADB the third Periodic Finance Request (PFR) covering state of Assam. This report has been prepared to serve the purpose for compliance with ADB’s social safeguards on involuntary resettlement and indigenous peoples during preparation of the RRNMUs and RCTRC subprojects in the state of Assam.

B. Status of RRNMUs and RCTRC in Assam

6. The proposed location of the pilot RRNMU is at Tezpur in Sonitpur district and the RCTRC is proposed to be located at Guwahati, the State Head Quarter. Both the buildings are proposed in land belonging to Assam PWD, the IA.

7. The proposed area under the two units are as under:

- **RCTRC:** A total of 3856 sqm has been identified for the construction of the new building. The built-up area of the building is 1583.88 sqm and set back area of 2272.12 sqm of land would be required as per the planning regulations.
- **Pilot RRNMU:** A total of 1638.92 sqm has been identified for the construction of the new building. The built up area of the building is 1423.72 sqm and set back area of 215.20 sqm of land would be required as per the planning regulations.

C. Social Safeguards in the Project

8. The pilot RRNMU and RCTRC buildings are located in land owned and under possession of Assam PWD. Locations of additional RRNMUs are yet to be finalized. To mitigate the possible adverse impacts of the subprojects, the community participation framework (CPF) lists various types of impact categories and mitigation measures which would apply to the subprojects, based on the specific project impacts.

Table 1: Mitigation Measures Matrix

| Impact Category | Mitigation Measures | Responsibility |
|----------------------------------|---|-------------------------------------|
| Loss of Agricultural Land | <ul style="list-style-type: none"> • Willing transfer of land by means of MOU • Advance notice to harvest standing crops • For vulnerable affected persons (APs), assistance/support by means of (a) alternate land sites provided by GP, or (b) cash assistance as per replacement cost¹ by the Gram Panchayat (GP) to meet loss of land; and inclusion as beneficiaries in the existing poverty alleviation/livelihood restoration programs (see Annex of relevant state Community Participation Framework) • For land involving traditional and tenurial rights, the legal provisions applicable of the central and state governments pertaining to transfer of land will be followed. Existing customary rights of the tribal communities on various categories of land shall be taken into account during the process of land transfer. | GP, PIU and land revenue department |
| Loss of Structure | <ul style="list-style-type: none"> • Provision of alternate plot of land and structure of equivalent quality and value to be provided as per AP's choice, or cash assistance by GP to meet the loss of land and structure allowing the AP to purchase land and rebuild structure of equivalent standard • For loss of boundary walls and fences, willing transfer by means of MOU. In case voluntary donation of such structures are not possible, cash assistance as per replacement cost by GP to meet loss of such structures, or provision of materials and/or labor by GP to allow the AP to replace/rebuild the same • For vulnerable APs, inclusion as beneficiaries in the rural development (RD) programs/housing schemes (see Annex of relevant state Community Participation Framework) | GP, PIU and land revenue department |

¹Replacement cost means the "cost" to replace the lost asset at current market value or its nearest equivalent, plus any transaction costs such as administrative charges, taxes, registration and titling costs allowing the individual / community to replace what is lost and their economic and social circumstances to be at least restored to the pre-project level.

| Impact Category | Mitigation Measures | Responsibility |
|--|---|-------------------------------------|
| Loss of Structure (Contd.) | <ul style="list-style-type: none"> For tenants, assistance to find alternative rental arrangements by GP, or cash assistance equivalent to advance payments made to the owner For squatters, provision of alternative relocation site, or cash assistance as per replacement cost, or provision of building material and/or labor by GP, or inclusion as beneficiaries in the RD programs/housing schemes. For land and structure involving traditional and tenurial rights, the legal provisions applicable of the central and state governments pertaining to transfer of land will be followed. Existing customary rights of the tribal communities on various categories of land shall be taken into account during the process of land transfer. | GP, PIU and land revenue department |
| Loss of livelihood | <ul style="list-style-type: none"> For vulnerable APs, inclusion as beneficiaries in the existing poverty alleviation /livelihood restoration programs (enumerated in Annex 9). In case of non inclusion in such programs, cash assistance to meet the loss of income during transitional phase and for income restoration. Assistance for asset creation² by community and Gram Panchayat. | GP and PIU |
| Loss of Assets such as Trees, Well, and Ponds | <ul style="list-style-type: none"> Willing transfer of the asset by means of MOU. For vulnerable APs, assistance for the loss of these assets through inclusion as beneficiaries in the existing poverty alleviation/livelihood restoration programs (enumerated in Annex 9). In case of non inclusion in such programs, cash assistance by GP to meet the loss of assets and income. | GP, PIU and land revenue department |
| Loss of community owned assets such as temple, wells, ponds, grazing land etc | <ul style="list-style-type: none"> Relocation or construction of asset by GP with technical inputs from PIU Consultations with the concerned section of the community in case of grazing land, etc | GP, PIU and land revenue department |
| Temporary impacts during construction | <ul style="list-style-type: none"> Civil works contract conditions to include provisions to obligate the contractor to implement appropriate mitigation measures for the temporary impacts include disruption of normal traffic, increased noise levels, dust generation, and damage to adjacent parcel of land due to movement of heavy machinery to be included the Civil Works Contract | PIU |
| Other impacts not identified | Unforeseen impacts will be documented and mitigated based on the principles in this Framework. | |

D. Approach and Methodology for Assessing Social Safeguards Compliance during preparation of the subprojects

9. The consultants visited both the sites for RCTRC building at Guwahati and the pilot RRNMU site at Tezpur and carried out consultations with the officials of Assam PWD at

² Assistance for asset creation shall comprise of assistance for creation of cattle shed, shop, production unit or any other form of income generating asset that will enable the affected household in restoring their livelihood.

Guwahati, PIU at Tezpur, Project Implementation Consultants (PIC) and PWD staff currently occupying the staff quarters/buildings at the proposed sites. They also carried out a desk review of the documents prepared for the project design, tender documents and the records of the land ownership.

10. The SRRDA with assistance from PIC conducted social safeguard screening of the proposed sites for the RCTRC and RRNMU. For the screening purpose a Social Safeguards Checklist was adopted that is presented in the appendices. As both the RCTRC and pilot RRNMU buildings are proposed in land owned and under possession of Assam PWD, there will be no need for monitoring of adverse impacts due to land requirement. However, monitoring will be carried out by the SRRDA through PIC support for alternate accommodation of PWD staff presently occupying the staff quarters at the proposed locations before start of the construction.



Site for RCTRC - Guwahati



Site for RRNMU – Tezpur

E. Findings

1. Land Ownership

11. Assam PWD, Implementing Agency of the project is the owner of the land for the proposed RCTRC and RRNMU sites at Guwahati and Tezpur respectively.

12. Written records of land ownership and letter confirming Assam PWD ownership of the land from Executive Engineer, Sonitpur PIU were verified.

2. Current Land use

a. Site for the Proposed RCTRC

13. The building is proposed within the premises of Assam Road Research and Training Institute (ARR&TI) complex belonging to Assam PWD at Guwahati. For the RCTRC complex including main building, the Director's residence, landscaped open area and the parking area, existing PWD staff quarters and some ancillary structures used for parking and common uses of PWD staff will be affected. The structures are old and PWD had plans to demolish these structures. PWD officials informed that alternate accommodation arrangements will be done for the PWD staff currently occupying these quarters within the ARR&TI complex before starting the construction of RCTRC buildings.

b. Site for the Pilot RRNMU Building

14. RRNMU is proposed on a hillock (26°37'17"N, 92°47'59"E) belonging to PWD, Assam located at Tezpur town in the district of Sonitpur, Assam. There are 3 adjacent hillocks located on the northern bank of the river Brahmaputra. DC's residence is located on one of the hillocks; the historic Agnigarh is on one hillock and Officer's club and PWD 4th grade staff quarters on the third hillock where the RRNMU building is proposed. The proposed site is located on the southern side of the DC residence and western side of Agnigarh hills.

3. Types of Loss and Affected Persons

a. Site for the RCTRC at Guwahati

15. The proposed RCTRC complex will affect existing old Assam type staff quarters and ancillary structures used as 'Naamghar' (community space for religious gathering) by the PWD staff and parking for PWD vehicles. All these structures belong to Assam PWD. The occupants of the quarters are PWD staff working in ARR&TI and will be provided with alternate accommodation in the existing quarters within the complex. The structures to be affected are old and PWD already had plans to demolish these structures.



b. Site for the Pilot RRNMU Building at Tezpur

16. Proposed RRNMU site at Tezpur will affect a dilapidated Assam type quarter occupied by PWD staff. Part of the quarter is already abandoned due to poor structural conditions. PWD already had plans to demolish these structures due to their poor conditions. The site is free from any encroachment. Alternate accommodation will be provided to the staff occupying the existing quarter before start of construction and the PIU has provided a written declaration to this effect.

Condition of Existing Staff Quarter at Proposed Pilot RRNMU Site – Tezpur



4.

4. Consultation with Affected Persons

17. Consultants had consultations with senior PWD officers (list attached in appendices) and the occupants of the quarters at the proposed sites for RCTRC and the pilot RRNMU. There were concerns raised by the occupants of the present quarters about accommodation when the existing structures will be dismantled. Higher ranked PWD officers accompanying the consultants assured that alternate accommodation to the staff will be provided.



Consultation at RCTRC Site



Consultation at RRNMU Site

5. Institutional Arrangements and Grievance Redress Mechanism

18. Assam PWD is the Implementing Agency. The present structures are occupied by the PWD staff for residential purpose. There is no encroachment either at the proposed RCTRC site or the pilot RRNMU site. All the affected persons being Assam PWD staff, there is a departmental procedure to address any grievances that might arise. The PIC is also in place to assist the PWD in addressing the safeguard issues in the project and monitoring of the related aspects.

F. Conclusion

19. The site visit and review of social assessment checklist prepared for the RCTRC and pilot RRNMU sites revealed that:

- i) Land is owned by Assam PWD, the implementing agency for both the sites proposed for RCTRC at Guwahati and pilot RRNMU at Tezpur.
- ii) All the occupants of the existing structures at the sites are PWD staff and they will be provided alternate accommodation before start of construction at the sites. There is no encroachment at any of the sites.
- iii) There was consultation with the present occupants of the staff quarters and information to them on the proposed projects.
- iv) Assam PWD has departmental procedure to address any grievances that might arise. PIC is in place to assist the PWD in monitoring of safeguard issues.

Appendix 1: Social Safeguards Checklist for RCTRC, Guwahati, Assam

1. Where is the RCTRC located?

RCTRC is proposed in the premise of the Assam Road Research and Training Institute (ARR&TI) located at Fatasil Ambari, Guwahati (26°09'34"N, 91°44'09"E) in the state of Assam.

2. What are the land requirements of the building (area size requirements)?

A total of 3856 sqm has been identified for the construction of the new building. The built-up area of the building is 1583.88 sqm and set back area of 2272.12 sqm of land would be required as per the planning regulations.

3. What is the current land use of this area?

The building is proposed within the premises of ARR&TI. The major part of the proposed building will be constructed in unutilized vacant land and a part of the building will fall on two old Assam Type PWD buildings located on the eastern part of the plot. Pre Registration Training Centre (PRTC) used to operate from one of the buildings (*Photo No. 4 provided in Annexure 1*) earlier and now it is used by one of the PWD 4th Grade staffs as residence. The other building is a PWD staff quarter.

4. Does some/all the land belong to the SRRDA? If all the land does, please provide documentation in annex and skip to question # 7

The land belongs to PWD, Government of Assam. Revenue records (Shitha) showing the ownership of the land is provided in **Annexure-2**. PWD, Assam has been bifurcated into two divisions viz. PWD (Roads) and PWD (Buildings). The plot of land where the RCTRC is proposed belongs to PWD (Buildings) but the process of transfer of this land to PWD (Roads) has been initiated and it would be completed before the commencement of civil works.

5. If the land does not belong to the SRRDA, is it government land? If yes, please describe share of land and size area belonging to government as well as procedures for SRRDA to acquire the government land.

Not Applicable as the land belongs to PWD, Assam.

6. Is some of the land private land? If yes describe the share and size of private land required and provide short brief census³ of affected households and survey of affected assets.

Not Applicable

7. If the land is SRRDA's or belong to another public entity, are there any structures, agricultural activities belonging/conducted by squatters on the plot? If yes, please conduct brief census of affected households and survey of affected assets.

³ Census should follow similar format as the one conducted for the Community Participation Framework

Two Assam Type PWD buildings are located on the plot of land. Since the structure belongs to SRRDA/PWD, no census survey is required. The PWD staffs residing in the buildings which are likely to be dismantled will be accommodated in other PWD quarters.

- 8. If answers to questions 6 and 7 are yes, please indicate mitigation measures as per the Mitigation Measure Matrix (Table 5.1 p. 2) of each state's Community Participation Framework (CPF). If any land/structures are donated, please describe participatory approach and provide substantiating documentation in annexes.**

Not Applicable

- 9. Additional comment (if any):**

None

Annexure RCTRC-1: Photographs and map showing the proposed site

The site for the proposed RCTRC building under RCIP for the state of Assam has been considered at the campus of the existing Road Research Laboratory (RRL), now designated as ARR & TI under PWD, Govt. of Assam.

The proposed construction will be on the eastern side of the campus. The location is so selected that there remains ample scope for future expansion of office and institutional building within the campus creating a hierarchy of open spaces for landscaping and parking. The building is proposed on a levelled ground and does not require any filling.

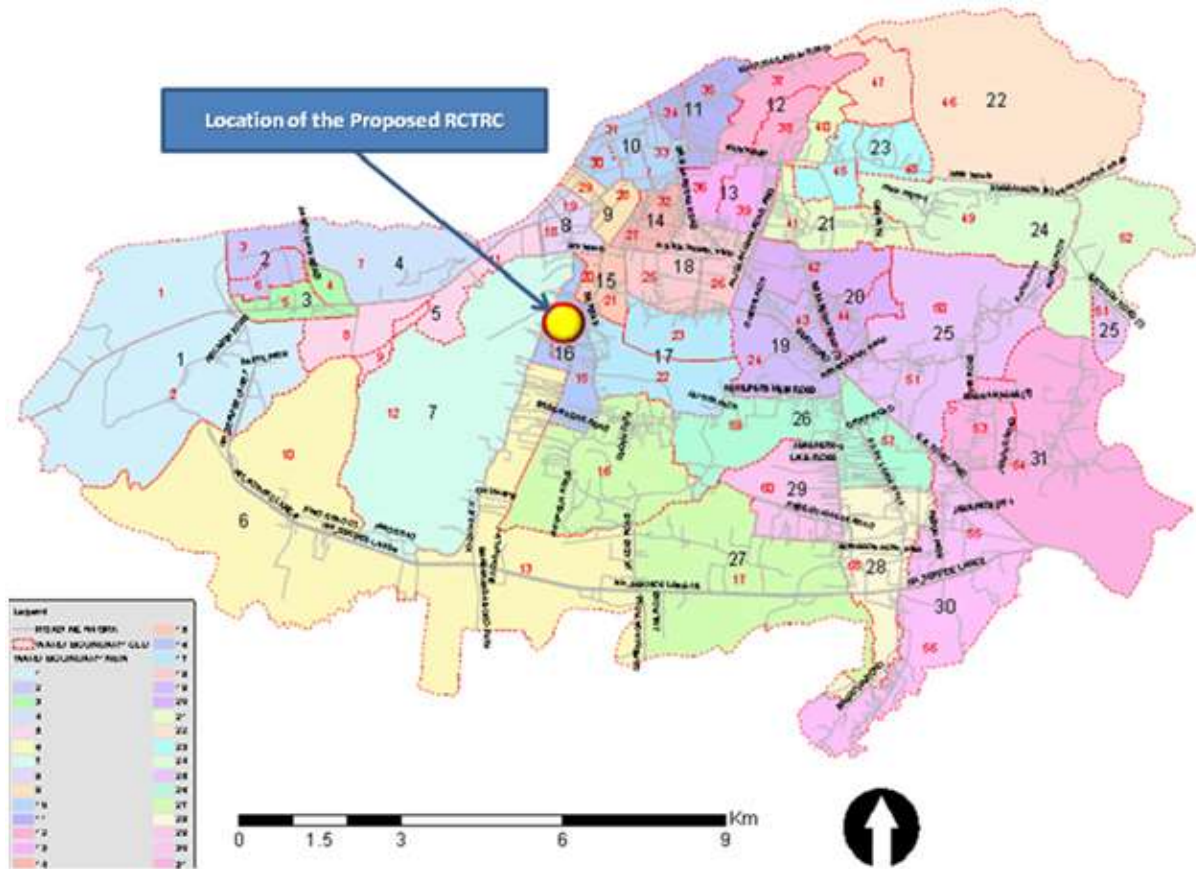

Figure 1: Location of the proposed RCTRC



Land Ownership Details for Proposed RCTRC Site



| Sl. No. | Block | Area (Sq. Mtr) | Revenue | Remarks |
|---------|-------|----------------|---------|---------|
| 1 | | | | |
| 2 | | | | |
| 3 | | | | |
| 4 | | | | |
| 5 | | | | |
| 6 | | | | |
| 7 | | | | |
| 8 | | | | |
| 9 | | | | |
| 10 | | | | |
| 11 | | | | |
| 12 | | | | |
| 13 | | | | |
| 14 | | | | |
| 15 | | | | |
| 16 | | | | |
| 17 | | | | |
| 18 | | | | |
| 19 | | | | |
| 20 | | | | |
| 21 | | | | |
| 22 | | | | |
| 23 | | | | |
| 24 | | | | |
| 25 | | | | |
| 26 | | | | |
| 27 | | | | |
| 28 | | | | |
| 29 | | | | |
| 30 | | | | |
| 31 | | | | |
| 32 | | | | |
| 33 | | | | |
| 34 | | | | |
| 35 | | | | |
| 36 | | | | |
| 37 | | | | |
| 38 | | | | |
| 39 | | | | |
| 40 | | | | |
| 41 | | | | |
| 42 | | | | |
| 43 | | | | |
| 44 | | | | |
| 45 | | | | |
| 46 | | | | |
| 47 | | | | |
| 48 | | | | |
| 49 | | | | |
| 50 | | | | |

Appendix 2: Social Safeguards Checklist for Due Diligence Review of the RRNMU, Tezpur, Assam

1. Where is the RRNMU located?

RRNMU is proposed on a hillock (26°37'17"N, 92°47'59"E) belonging to PWD, Assam located at Tezpur town in the district of Sonitpur, Assam. There are 3 adjacent hillocks located on the northern bank of the river Brahmaputra. DC's residence is located on one of the hillocks; the historic Agnigarh is on one hillock and Officer's club and PWD 4th grade staff quarters on one hillock where the RRNMU building is proposed. The Agnigarh hill and the proposed site is separated from the DC's residence by a black topped road of width 6m (approx). The proposed site is located on the southern side of the DC residence and western side of Agnigarh hills.

2. What are the land requirements of the building (area size requirements)?

A total of 1638.92 sqm has been identified for the construction of the new building. The built up area of the building is 1423.72 sqm and set back area of 215.20 sqm of land would be required as per the planning regulations.

3. What is the current land use of this area?

Quarters of 4th grade staffs of PWD (Roads), Tezpur, Assam are located at the proposed site.

4. Does some/all the land belong to the SRRDA? If all the land does, please provide documentation in annex and skip to question # 7

The building is proposed on a plot of land owned by PWD, Assam, which is presently housing quarters of PWD 4th Grade staffs. The certificate confirming the ownership of the land is given in Annex-2.

5. If the land does not belong to the SRRDA, is it government land? If yes, please describe share of land and size area belonging to government as well as procedures for SRRDA to acquire the government land.

Not Applicable as the land belongs to PWD, Assam.

6. Is some of the land private land? If yes describe the share and size of private land required and provide short brief census⁴ of affected households and survey of affected assets.

Not Applicable

7. If the land is SRRDA's or belong to another public entity, are there any structures, agricultural activities belonging/conducted by squatters on the plot? If yes, please conduct brief census of affected households and survey of affected assets.

⁴ Census should follow similar format as the one conducted for the Community Participation Framework

Quarters of PWD staffs are located on the plot. These structures are very old and in a dilapidated condition, so the PWD, Assam has decided to dismantle these structures and construct the proposed RRNMU building. Since the structures belong to PWD, Assam and not to any private individuals, census survey would not be required. The families residing in the quarters would be relocated to some other PWD quarters. The PWD, Tezpur has already initiated the process for their relocation, which has been confirmed by the Executive Engineer, Sonitpur State Road Division, PWD, Assam. (See Annex-3)

- 8. If answers to questions 6 and 7 are yes, please indicate mitigation measures as per the Mitigation Measure Matrix (Table 5.1 p. 2) of each state's Community Participation Framework (CPF). If any land/structures are donated, please describe participatory approach and provide substantiating documentation in annexes.**

Not Applicable

- 9. Additional comment (if any)**

None

Annexure RRNMU-1: Photographs and map showing the proposed site

The RRNMU is proposed in a hillock, located on the northern bank of the river Brahmaputra, which is housing a few PWD quarters. The proposed site is well within the limit of the Tezpur town and is in close proximity to the office of the Superintending Engineer and Executive Engineer, PWD, Sonitpur district.

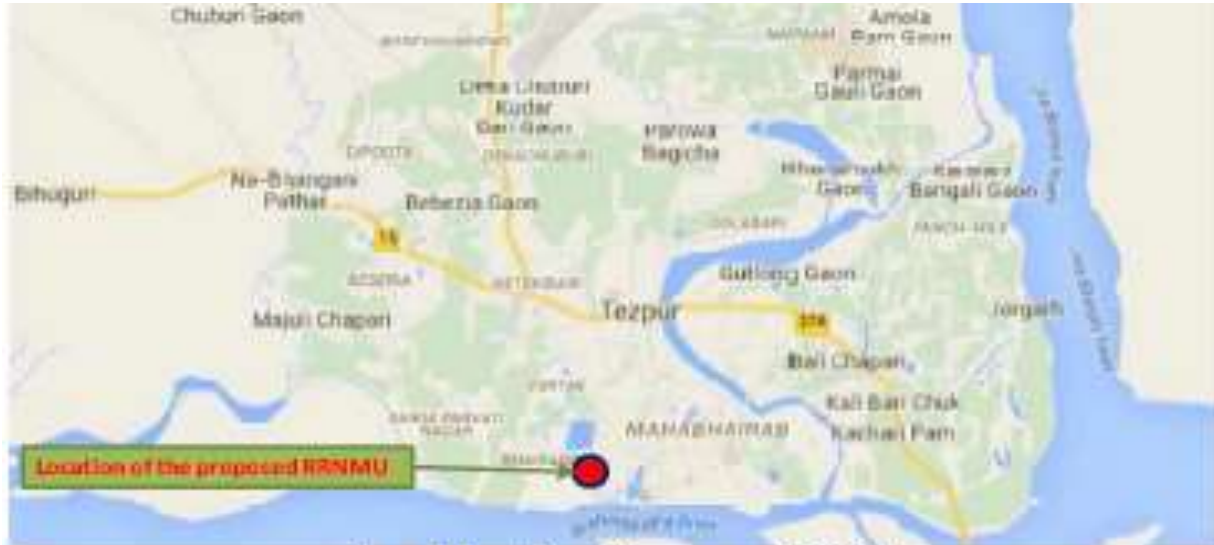

Figure 1: Location of the proposed RRNMU



Figure 2: Sub- Project Area (RRNMU)



Figure 3: Drawing of the proposed site (RRNMU)

Annexure 3: Assurance of relocation of staffs

GOVERNMENT OF ASSAM
OFFICE OF THE EXECUTIVE ENGINEER, PWD:::SONITPUR STATE
ROAD DIVISION:::TEZPUR.

No. C/1501/R/2014-15/

2535

Date:- 24/12 /2014

TO WHOM IT MAY CONCERN

Certified that the family living within proposed RRNMU Building area will be shifted and rehabilitate them to other PWD Buildings. The rehabilitation process is in progress. In this connection a decision was taken in the meeting of Departmental Building Allotment Committee at Addl. Chief Engineer, PWD (Roads) office on 26/11/2014 (copy enclosed).

Yours faithfully,

(A. K. Dutta)

Executive Engineer, PWD.

Sonitpur State road Division, Tezpur

List of Officials Consulted

SRRDA

Mr. S M Hasan, Addl. Chief Engineer, PWD, Assam
Mr. D Saharia, SE, Guwahati
Mr. B Saikia, EE, Guwahati Road Division,
Mr. G Saikia, SE, Office of CE, PWD (R), Guwahati
Mr. P Barua, AEE, Office of CE, PWD (R), Guwahati
Mr. S Saikia, AE, Office of CE, PWD (R), Guwahati
Mr. K Ahmed, AE, Guwahati Road Division, ARR&TI
Mr. A K Datta, EE, Sonitpur

PIC

Mr. M Kaalimuthu, Team Leader, PIC
Mr. B K Bezbarua, PIC

II. RURAL CONNECTIVITY INVESTMENT PROGRAM: PROJECT 3 –CHHATTISGARH SOCIAL SAFEGUARDS COMPLIANCE – RRNMUs and RCTRC

A. Context and Purpose of the Report

1. The Government of India (GOI) launched “The Pradhan Mantri Gram Sadak Yojna (PMGSY) in 2000, with the objective to provide all-weather road connectivity to all rural habitations with a population of more than 500 persons in plains and 250 persons in hill states. This program is being implemented through the National Rural Road Development Authority (NRRDA) under the Ministry of Rural Development (MORD) at central level and through the State Rural Road Development Authority/Agencies (SRRDA) at state level.

2. The Rural Connectivity Investment Program (RCIP) supports PMGSY through a multi-Project Financing Facility (MFF) that will construct or upgrade to all-weather standards 3,998 rural roads equivalent to 13,884 km, and connecting 5,238 habitations in the states of Assam, Chhattisgarh, Odisha, Madhya Pradesh and West Bengal (RCIP states). Investments in rural roads will improve connectivity, cut transport costs, and provide enabling infrastructure to areas currently with poor access to markets and urban towns, and thus contribute to growth and equity in the country’s largest sector.

3. RCIP is divided into three separate projects. Project 1 and Project 2 of US\$252 million, and \$US 275 million respectively, were approved in 2013 and are ongoing. Project 3 is expected to be approved at the end of 2015 with an estimated cost of USD 518.30 million.

4. Under RCIP Project 1 (Loan 2881-IND), each State is to establish one pilot RRNMU. Later during RCIP Project 3 (Tranche 3) approximately five additional RRNMUs (30 RRNMUs in total) are planned to be created. The RRNMUs shall be created based on the existing PIUs for rural roads and shall have staffing, equipment, and facilities adequate to provide effective management of the rural road network. The States shall ensure full RRNMU staffing and budget adequate for the full implementation of RRNMU tasks. The States shall prepare the design of RRNMU facilities. Similarly, under RCIP Project 1 (Loan 2881-IND) each State is to establish one RCTRC with the main objective to (i) conduct systematic training of engineers involved in the management of the rural road network, technicians, site supervisors, concerned staff of Panchayati Raj institutions, design consultants and contractors, and (ii) support a sustainable practice-oriented research on rural roads. The RCTRCs shall have staffing, equipment, and facilities adequate to provide high-quality and large scale training, both in house and with the use of external resource persons. Each State shall ensure full RCTRC staffing and budget adequate for the full implementation of RCTRC tasks. Like the RRNMUs, the States shall prepare the design of RCTRC facilities. The Chhattisgarh Rural Road Development Authority (CGRRDA) is the implementing agency (IA) for the ADB funded subprojects in the state.

5. The Government is now planning to submit to ADB the third Periodic Finance Request (PFR) covering state of Chhattisgarh. This report has been prepared to serve the purpose for compliance with ADB's social safeguards on involuntary resettlement and indigenous peoples during preparation of the RRNMUs and RCTRC subprojects in the state of Chhattisgarh.

B. Status of RRNMUs and RCTRC in Chhattisgarh

6. Both RCTRC and the pilot RRNMU are proposed in Raipur district. While the RCTRC is proposed within the existing State Institute of Rural Development (SIRD) complex at Nimora,

the pilot RRNMU is proposed at sector-24 near village Jhanj in Naya Raipur. Land at both the locations is under the Panchayat and Rural Development Deptt., Govt. of Chhattisgarh.

7. The proposed area under the two units are as under:

- **RCTRC:** Land allocated for construction of RCTRC building is 2106 sqm within the SIRD complex (also called as Thakur Pyarelal Institute for Panchayat and Rural Development). Ground plus 2 stories have been planned to be constructed.
- **Pilot RRNMU:** Land allocated for construction of RRNMU building is 1842 sq m. Initially both RCTRC as well as RRNMU were planned to be located at this site in Naya Raipur Development Authority (NRDA) Area. Later it was decided to locate the RCTRC within the existing SIRD campus at Nimora. Presently, the total land of 3573 sqm (1842 sqm for RRNMU+1731 sqm for RCTRC) is under the possession of Panchayat and Rural Development Deptt., Govt. of Chhattisgarh at Sector-24, Naya Raipur..

C. Social Safeguards in the Project

8. The pilot RRNMU and RCTRC buildings are located in land owned and under possession of Deptt. of Panchayat and Rural Development, Govt. of Chhattisgarh. Locations of additional RRNMUs are yet to be finalized. To mitigate the possible adverse impacts of the subprojects, the community participation framework (CPF) lists various types of impact categories and mitigation measures which would apply to the subprojects, based on the specific project impacts.

Table 2: Mitigation Measures Matrix- Chhattisgarh

| Impact Category | Mitigation Measures | Responsibility |
|---------------------------|---|-------------------------------------|
| Loss of Agricultural Land | <ul style="list-style-type: none"> • Willing transfer of land by means of MOU • Advance notice to harvest standing crops • For vulnerable affected persons (APs), assistance/support by means of (a) alternate land sites provided by GP, or (b) cash assistance as per replacement cost⁵ by the Gram Panchayat (GP) to meet loss of land; and inclusion as beneficiaries in the existing poverty alleviation/livelihood restoration programs (see Annex of relevant state Community Participation Framework) • For land involving traditional and tenurial rights, the legal provisions applicable of the central and state governments pertaining to transfer of land will be followed. Existing customary rights of the tribal communities on various categories of land shall be taken into account during the process of land transfer. | GP, PIU and land revenue department |

⁵Replacement cost means the "cost" to replace the lost asset at current market value or its nearest equivalent, plus any transaction costs such as administrative charges, taxes, registration and titling costs allowing the individual / community to replace what is lost and their economic and social circumstances to be at least restored to the pre-project level.

| Impact Category | Mitigation Measures | Responsibility |
|--|---|-------------------------------------|
| Loss of Structure | <ul style="list-style-type: none"> • Provision of alternate plot of land and structure of equivalent quality and value to be provided as per AP's choice, or cash assistance by GP to meet the loss of land and structure allowing the AP to purchase land & rebuild structure of equivalent standard • For loss of boundary walls and fences, willing transfer by means of MOU. In case voluntary donation of such structures are not possible, cash assistance as per replacement cost by GP to meet loss of such structures, or provision of materials and/or labor by GP to allow the AP to replace/rebuild the same • For vulnerable APs, inclusion as beneficiaries in the rural development (RD) programs/housing schemes (see Annex of relevant state Community Participation Framework) | GP, PIU and land revenue department |
| Loss of Structure (Contd.) | <ul style="list-style-type: none"> • For tenants, assistance to find alternative rental arrangements by GP, or cash assistance equivalent to advance payments made to the owner • For squatters, provision of alternative relocation site, or cash assistance as per replacement cost, or provision of building material and/or labor by GP, or inclusion as beneficiaries in the RD programs/housing schemes. • For land and structure involving traditional and tenurial rights, the legal provisions applicable of the central and state governments pertaining to transfer of land will be followed. Existing customary rights of the tribal communities on various categories of land shall be taken into account during the process of land transfer. | GP, PIU and land revenue department |
| Loss of livelihood | <ul style="list-style-type: none"> • For vulnerable APs, inclusion as beneficiaries in the existing poverty alleviation /livelihood restoration programs (enumerated in Annex 9). In case of non inclusion in such programs, cash assistance to meet the loss of income during transitional phase and for income restoration. • Assistance for asset creation⁶ by community and Gram Panchayat. | GP and PIU |
| Loss of Assets such as Trees, Well, and Ponds | <ul style="list-style-type: none"> • Willing transfer of the asset by means of MOU. • For vulnerable APs, assistance for the loss of these assets through inclusion as beneficiaries in the existing poverty alleviation/livelihood restoration programs (enumerated in Annex 9). In case of non inclusion in such programs, cash assistance by GP to meet the loss of assets and income. | GP, PIU and land revenue department |
| Loss of community owned assets such as temple, wells, ponds, grazing land etc | <ul style="list-style-type: none"> • Relocation or construction of asset by GP with technical inputs from PIU • Consultations with the concerned section of the community in case of grazing land, etc | GP, PIU and land revenue department |

⁶ Assistance for asset creation shall comprise of assistance for creation of cattle shed, shop, production unit or any other form of income generating asset that will enable the affected household in restoring their livelihood.

| Impact Category | Mitigation Measures | Responsibility |
|--|---|----------------|
| Temporary impacts during construction | <ul style="list-style-type: none"> Civil works contract conditions to include provisions to obligate the contractor to implement appropriate mitigation measures for the temporary impacts include disruption of normal traffic, increased noise levels, dust generation, and damage to adjacent parcel of land due to movement of heavy machinery to be included the Civil Works Contract | PIU |
| Other impacts not identified | Unforeseen impacts will be documented and mitigated based on the principles in this Framework. | |

D. Approach and Methodology for Assessing Social Safeguards Compliance during preparation of the subprojects

9. The consultants visited both the sites for RCTRC building at Nimora and the pilot RRNMU site at Sector-24 of Naya Raipur and carried out consultations with the officials of CGRRDA at Raipur, designated staffs of RCTRC at Nimora, Project Implementation Consultants (PIC). Both the sites are vacant and free from any encumbrances. They also carried out a desk review of the documents prepared for the project design, tender documents and the departmental orders for locating the proposed centres at the designated sites.

10. The SRRDA with assistance from PIC conducted social safeguard screening of the proposed sites for the RCTRC and RRNMU. For the screening purpose a Social Safeguards Checklist was adopted that is presented in the appendices. As both the RCTRC and pilot RRNMU buildings are proposed in land owned and under possession of Panchayat and Rural Development Department, Govt. of Chhattisgarh; the parent department of CGRRDA, there will be no need for monitoring of adverse impacts due to land requirement. However, PIC will provide monitoring support to the SRRDA for issues that might arise during execution of the project.



Site for RCTRC - Nimora



Site for RRNMU – Sector-24, Naya Raipur

E. Findings

1. Land Ownership

11. Panchayat and Rural Development Deptt., Govt. of Chhattisgarh, parent department of CGRRDA (Implementing Agency of the project) is the owner of the land for the proposed RCTRC and RRNMU sites at Nimora SIRD complex and Naya Raipur respectively.

12. Letters from Panchayat and Rural Development Deptt., Govt. of Chhattisgarh giving approval for locating the RCTRC and RRNMU at the proposed sites, PIU Raipu taking possession of the land for the RRNMU site and letter from NRDA confirming possession of the land by PIU Raipur for the RRNMU building are annexed with the checklist prepared by the PIC for CGRRDA and these were verified by the consultants.

2. Current Land use

a. Site for the Proposed RCTRC

13. The building is proposed within the premises of SIRD complex at Nimora belonging to Panchayat and Rural Development Deptt., Govt. of Chhattisgarh. The proposed site is vacant and devoid of any structures. The site proposed will have the administrative block of the RCTRC and facilities already available at the SIRD complex viz. guest house, hostels etc. will be utilised for the trainees of RCTRC.

b. Site for the Pilot RRNMU Building

14. RRNMU is proposed on a plot of land opposite Jhanj village in Sector-24 of Naya Raipur. At present the plot is vacant. The Naya Raipur town is a well planned new capital city for the state of Chhattisgarh; the approach road to the proposed site and other service networks are at various stages of development.

3. Types of Loss and Affected Persons

15. Both the sites proposed for the RCTRC and the pilot RRNMU are vacant plots without any structure and encroachment. The RCTRC plot is within the boundary walls of the existing SIRD complex. Although CGRRDA has already taken possession of the plot for the pilot RRNMU, it is yet to have boundary fence.

4. Consultation with Affected Persons

16. Consultants had consultations with senior officers of CGRRDA, State Institute of Rural Development and the PIC (list attached in the appendices). There were some concerns about the accommodation of the staff designated for the RCTRC as the location at Nimora is over 30 km from the existing Raipur town. However, the new Raipur city coming up fast, the existing office set up at Raipur and staff accommodations are likely to be shifted to the new capital; the distance to both the locations will be well within reasonable distance of travel for the staff.



Consultation at RCTRC Site



Consultation at RRNMU Site

5. Institutional Arrangements and Grievance Redress Mechanism

17. CGRRDA is the Implementing Agency. The land for both the RCTRC and RRNMU site belong to Panchayat and Rural Development Deptt., Govt. of Chhattisgarh. There is no encroachment in any of the two sites. There is a government departmental procedure to address any grievances that might arise. The PIC is also in place to assist CGRRDA in addressing the safeguard issues in the project and monitoring of the related aspects.

F. Conclusion

18. The site visit and review of social assessment checklist prepared for the RCTRC and pilot RRNMU sites revealed that:

- a. Land is owned by Panchayat and Rural Development Deptt., Govt. of Chhattisgarh, the parent department of the implementing agency (CGRRDA) for both the sites proposed for RCTRC at Nimora and pilot RRNMU at Naya Raipur.
- b. Both the land parcels proposed for RCTRC and pilot RRNMU are vacant. There is no encroachment at any of the sites.
- c. There was consultation with officials of CGRRDA, designated staff for the RCTRC and PIC. The concerns relating to travel distance from existing Raipur city to Nimora is temporary and will be addressed by the time the buildings are completed and become functional.
- d. CGRRDA has departmental procedure to address any grievances that might arise. PIC is in place to assist CGRRDA in monitoring of safeguard issues.

Appendix 1: Social Safeguards Checklist for due diligence review of the Pilot for RCTRC In Raipur, CG

1. Where is the RCTRC located?

The land for proposed for RCTRC has been allotted in the campus of Sate Institute of Rural Development (SIRD) - Thakur Pyarelal Institute for Panchayat and Rural Development. (TPIPRD). SIRD is located approximately 30 km from the Raipur city on Dhamtari Highway AT Nimora.

The institute has administrative building, hostels, classrooms, conference halls and video conferencing facility. The purpose of locating RCTRC in the campus is to integrate and utilize the facilities that are already available in the institute for the RCTRC also..

Pls Refer Photo no 1, 2, 3 in Annex – A

2. What are the land requirements of the building (area size requirements)?

The land allocated for construction of RCTRC building is 2106 sq m. Ground plus 2 stories have been planned to be constructed.

Please Refer annex- B1, B2

3. What is the current land use of this area?

Presently the land is lying open and vacant in the campus of SIRD.

Pls Refer Photo no 4, 5, 6 in annex - A

4. Does some/all the land belong to the SRRDA? If all the land does, please provide documentation in annex and skip to question # 7

Yes. The land belongs to Panchayat and Rural Development Department, Government of Chhattisgarh which is the parent department of CGRRDA.

5. If the land does not belong to the SRRDA, is it government land? If yes, please describe share of land and size area belonging to government as well as procedures for SRRDA to acquire the government land.

Yes, it is Government Land. Both the SIRD and CGRRDA are under Panchayat and Rural Development Department, Government of Chhattisgarh. Demarcated land has been allocated to CGRRDA vide letter no -8765/RC-5/CG/ADB 2014 dated 05/08/2014. Pls refer annex B1

6. Is some of the land private land? If yes describe the share and size of private land required and provide short brief census⁷of affected households and survey of affected assets

No. there is no share of private land.

⁷Census should follow similar format as the one conducted for the Community Participation Framework

7. If the land is SRRDA's or belong to another public entity, are there any structures, agricultural activities belonging/conducted by squatters on the plot? If yes, please conduct brief census of affected households and survey of affected assets

No. There is no structure on the land and it is not being used for any agriculture activity. The land lies within the closed campus of SIRD, there are no squatters on the plot.

8. If answers to questions 6 and 7 are yes, please indicate mitigation measures as per the Mitigation Measure Matrix (Table 5.1 p. 2) of each state's Community Participation Framework (CPF). If any land/structures are donated, please describe participatory approach and provide substantiating documentation in annexes.

Not applicable.

9. Additional comment (if any):

While it will take some time for the RCTRC building to be constructed, it is now functional from the Administrative building of SIRD.

CG Panchayat and Rural Development Department has already allocated one hall for the staff of RCTRC and one room for the Director of RCTRC vide letter no TPIPRD/2014/1819 dated 18/07/2014 within the SIRD.

Pls refer Annex A and Annex B3



Approach Road to SIRD Complex



Entry to Existing SIRD



Main Building of SIRD Complex



Existing Hostel within SIRD Complex



Location for Proposed RCTRC Building



Office for Staff allocated to RCTRC

Annexure – B!

छत्तीसगढ़ शासन
पंचायत एवं ग्रामीण विकास विभाग,
महानदी भवन, मंत्रालय, नया रायपुर

भाग संख्या: 5 / RCTC/पंचायत एवं ग्रामीण विकास विभाग/2014 रायपुर दिनांक: 28/08/2014

// सापेक्ष //

रायपुर शहर के अंतर्गत, नंदयका एवं तामीर निवास संस्थान, निमोरा, नरसपुर के परिसर में नए/पुराने मकानों में High Light कर प्रसारित करने हेतु एक 1.5 एअर 2136 वर्ग मीटर में छत्तीसगढ़ ग्रामीण सड़क विकास अभिकरण के प्रादेशीय निदेशक को अधीन Rural Connectivity Training and Research Centre (RCTRC) भवन के निर्माण की एतद्, द्वारा स्वीकृति प्रदान की जाती है।



(श्री श्री शंकर प्रसाद शर्मा)

उप सचिव

छत्तीसगढ़ शासन

पंचायत एवं ग्रामीण विकास विभाग

पु. सं. क्र. 5 / RCTC/पंचायत एवं ग्रामीण विकास विभाग/2014 रायपुर दिनांक: 28/08/2014
प्रतिलिपि:

1. मुख्य कार्यपालक अधिकारी, छत्तीसगढ़ ग्रामीण सड़क विकास अभिकरण (स्थिति: आई.सी. रायपुर, छिन्ना)
2. संचायक, आर.ए.ए. शिबपुर, नंदयका एवं तामीर निवास संस्थान, निमोरा जिला-नरसपुर (एतद्) की ओर सूचनाएं एवं आवश्यक कार्यवाही हेतु अधिसूचना।



उप सचिव

छत्तीसगढ़ शासन

पंचायत एवं ग्रामीण विकास विभाग

SANCTION LETTER TO LOCATE RCTRC IN SIRD COMPLEX AT NIMORA

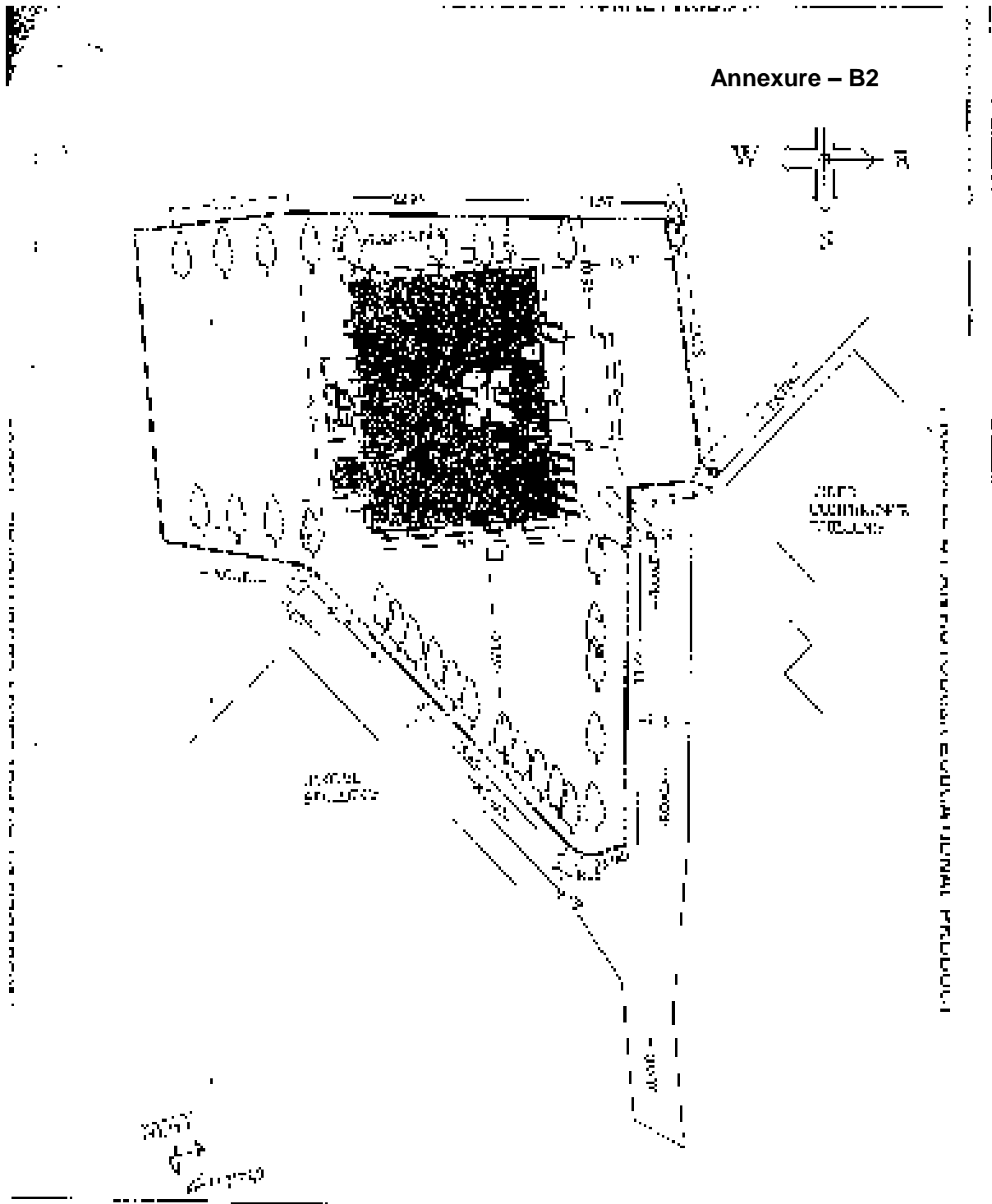

| | | |
|--|-------------------|---|
| <p>PROPOSED SITE PLAN OF SOM BUILDING NO-4</p> | <p>DATE: 2024</p> | <p>SHRIVASTAVA, BAGROCHA & ASSOCIATES ENGINEERS ARCHITECTS & INTERIOR DESIGNERS</p> |
|--|-------------------|---|

PROPOSED SITE PLAN FOR RCTRC BUILDING AT NIMORA

ORDER FOR TEMPORARY OFFICE OF RCTRC STAFF IN SIRD COMPLEX

Annexure – B3

डा. सुरेश प्रसाद लाल भेंवायत एवं ग्रामीण विकास संस्थान, निमोरा
पो. बालासागर नगर 10, पञ्जाब डाक भंडार रायपुर (छ.ग.) पिन नंबर 492039

क्र. 18/2014/2023/2024/1819

दिनांक: 18/07/2024

प्रति

मुख्य कार्यालय अधिकारी,
छत्तीसगढ़ ग्रामीण विकास अभिव्यक्ति
सिबिल लाईन्स रायपुर

विषय : RCTRC को वैकल्पिक रूप से प्रदेश में प्राप्ति करने के संबंध में
संलग्न - आपका कार्यकारी पत्र क्रमांक 18/2014/ए.डी.सी./30 संलग्न सविन
18/2024 रायपुर दिनांक 18/07/2024 ।

—00

कृपया ध्यानपूर्वक पत्र का अध्ययन करें। मानव संसाधन संस्थान - RCTRC को
वैकल्पिक रूप से स्थापित करने हेतु सहायक अधिकारी को अनुदान की प्रक्रिया में
निम्नलिखित कार्रवाई करना भी जारी है -

18/2014/2023/2024/1819

1. RCTRC के कार्यक्षेत्र को वैकल्पिक रूप से आगमन व्यवस्था करने हेतु आर.डी.सी. में
प्रस्तावित मान्यता के अन्तर्गत दो एक एक कर एक दिन की छुट्टी प्रदान की जा
येगी। कृपया इसे विद्वान पीछे नमाना हो, विशेष ध्यान देकर प्रस्ताव को मान्य
करना होगा।
2. RCTRC स्थापित करने हेतु शीघ्र प्रयास करना है। इसके लिए विभिन्न संस्थाओं
के माध्यम से आवश्यक कक्षा अनुदान हो। RCTRC को वैकल्पिक रूप से
स्थापित।
3. RCTRC कार्यक्षेत्र एवं निर्माण के प्रस्ताव आर.डी.सी. द्वारा स्वीकृत होने पर
देशीय कर्मियों हेतु, संस्था के प्रदेश - जहाँ से वे कार्य कर रहे हैं, के लिए
विमान और राशन कार्ड आदि आवश्यकताओं को आवश्यक संस्थान / संस्था द्वारा निर्धारित रूप
में उनके सुविधा पर व्यवस्थापक द्वारा किया जा सके।

18/2014/2023/2024/1819

—

समाप्त

डा. सुरेश प्रसाद लाल भेंवायत एवं ग्रामीण विकास संस्थान
निमोरा, पञ्जाब, भारत

Appendix 2: Social Safeguards Checklist for Pilot RRNMU In Naya Raipur, CG

1. Where is the RRNMU located?

The land for proposed for RRNMU has been allotted in the recently developed area "Naya Raipur" by Naya Raipur Development Authority (NRDA). It is located approximately 25 - 30 km from the Raipur city. The Land is in Secor 24 near village Janjh. NRDA is developing the capital city of CG 'Naya Raipur' which will house all the Govt offices including Assembly and Secretariat buildings, which are already functional.

Pls Refer Photo no1,2,3,4 in Annex – A and B1 B2

2. What are the land requirements of the building (area size requirements)?

The Area of land allocated for construction of RRNMU building is $(1842 + 1731) = 3573$ sq m.

It is important to note that initially both RCTRC as well as RRNMU were planned to be located side by side in NRDA Area. But later on the RCTRC was shifted to SIRD campus and now complete land area of 3573 sq m is available for RRNMU with CGRRDA.

Please Refer annex B1,B2,B3

3. What is the current land use of this area?

Presently the land is lying open and vacant in the NRDA Area.

Pls Refer Photo no 1,2,3,4 in annex - A

4. Does some/all the land belong to the SRRDA? If all the land does, please provide documentation in annex and skip to question # 7

Yes. The entire plot is under possession of land CGRRDA.

5. If the land does not belong to the SRRDA, is it government land? If yes, please describe share of land and size area belonging to government as well as procedures for SRRDA to acquire the government land.

Yes, it is Government Land.

CGRRDA has already taken the possession of the demarcated land. The possession letter dated 11.03.2013 has been issued by NRDA. Refer Annex B.

6. Is some of the land private land? If yes describe the share and size of private land required and provide short brief census⁸of affected households and survey of affected assets

No. There is no share of private land.

⁸Census should follow similar format as the one conducted for the Community Participation Framework

7. If the land is SRRDA's or belong to another public entity, are there any structures, agricultural activities belonging/conducted by squatters on the plot? If yes, please conduct brief census of affected households and survey of affected assets

There is no structure on the land and it is not being used for any agriculture activity. There are no squatters on the plot.

8. If answers to questions 6 and 7 are yes, please indicate mitigation measures as per the Mitigation Measure Matrix (Table 5.1 p. 2) of each state's Community Participation Framework (CPF). If any land/structures are donated, please describe participatory approach and provide substantiating documentation in annexes.

Not applicable.

9. Additional comment (if any):

While it will take some time for the RRNMU building to be constructed, it is functional from existing Raipur PIU at Raipur.

Pls refer Annex A photo No. 5 and 6



PHYSICAL SURVEY OF LAND BY CGRDA OFFICERS AND PIC STAFF ALLOCATED FOR RRNMU+RCTRC AT SECTOR-24, NAYA RAIPUR



EXISTING LAND USE AT THE PROPOSED SITE FOR RRNMU



EXISTING RRNMU OFFICE AT RAIPUR

Possesion Letter from NRDA

Annexure – RRNMU B1

नया रायपुर डेव्हलपमेंट अथारिटी
नॉबिल सेंटर (डिजीटल प्लॉ) नं. ३७००० नगर, नैकर, रायपुर (छत्तीसगढ़)

कृपया प्रमाण पत्र

आज दिनांक २४ सितंबर २०२४ में कलम १७३१ एमएचएच अधिनियम के अंतर्गत आधिकारिक तौर पर दिनांक ११/०३/२०१९ को सत्यापित, मुद्रांकित और इस प्रकार प्रमाणित किया गया कि नया रायपुर डेव्हलपमेंट अथारिटी की एक कलम (एड) की प्लॉ नंबर ३७००० में उपरोक्त में उल्लिखित प्लॉ में विभाजन अनुसार कलम पर कलम प्रमाणित है।

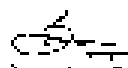
कलम देने वाले अधिकारी
एन प्रमोद सिंह, एमएचएच
अवर डि. इंफोर्मांट
आर.डी.ओ.
आर.डी.ओ. नं. १-२०२४

कलम देने वाले अधिकारी
एन प्रमोद सिंह, एमएचएच

Approval Letter from Panchayat and Rural Development Deptt. Govt. CG to NRDA for RRNMU and RCTRC

Annexure – RRNMU B 2

छत्तीसगढ़ शासन
नवीन एवं ग्रामीण विकास विभाग
नवलपुर, मंडलाई कक्षा, नया रायपुर

दिनांक: 10.12/2012/RRNMU-अन्वय/308/2012 संख्या: 308/2012/RRNMU-अन्वय/308/2012

शुद्ध संयोजक श्री/श्री
एम. मन्मथ सिंह/एम. मन्मथ सिंह NRDA,
नवीन एवं ग्रामीण विकास विभाग, नवलपुर कक्षा

- विषय- नया रायपुर में छत्तीसगढ़ ग्रामीण सड़क विकास समितियों को RRNMU एवं RRTRD की सेवा हेतु नवीन संयोजक आदेश
- संदर्भ-1. आदेश सं. 308/2012/अन्वय/एम. मन्मथ सिंह/2012 संयुक्त संविधान 29/2012
- 2. आदेश सं. 308/2012/अन्वय/एम. मन्मथ सिंह/2012 संयुक्त संविधान 33/2012

1. नवीन एवं ग्रामीण विकास विभाग, नवलपुर कक्षा, नया रायपुर में नवीन एवं ग्रामीण विकास विभाग (RRNMU) को सेवा हेतु नवीन संयोजक आदेश सं. 308/2012/अन्वय/एम. मन्मथ सिंह/2012 संविधान 29/2012 का प्रकाशन किया गया है। संयोजक आदेश सं. 308/2012/अन्वय/एम. मन्मथ सिंह/2012 संविधान 33/2012 के अन्तर्गत नवीन एवं ग्रामीण विकास विभाग (RRNMU) को सेवा हेतु नवीन संयोजक आदेश सं. 308/2012/अन्वय/एम. मन्मथ सिंह/2012 संविधान 29/2012 का प्रकाशन किया गया है। संयोजक आदेश सं. 308/2012/अन्वय/एम. मन्मथ सिंह/2012 संविधान 33/2012 के अन्तर्गत नवीन एवं ग्रामीण विकास विभाग (RRNMU) को सेवा हेतु नवीन संयोजक आदेश सं. 308/2012/अन्वय/एम. मन्मथ सिंह/2012 संविधान 29/2012 का प्रकाशन किया गया है।

2. नवीन एवं ग्रामीण विकास विभाग (RRNMU) को सेवा हेतु नवीन संयोजक आदेश सं. 308/2012/अन्वय/एम. मन्मथ सिंह/2012 संविधान 29/2012 का प्रकाशन किया गया है। संयोजक आदेश सं. 308/2012/अन्वय/एम. मन्मथ सिंह/2012 संविधान 33/2012 के अन्तर्गत नवीन एवं ग्रामीण विकास विभाग (RRNMU) को सेवा हेतु नवीन संयोजक आदेश सं. 308/2012/अन्वय/एम. मन्मथ सिंह/2012 संविधान 29/2012 का प्रकाशन किया गया है। संयोजक आदेश सं. 308/2012/अन्वय/एम. मन्मथ सिंह/2012 संविधान 33/2012 के अन्तर्गत नवीन एवं ग्रामीण विकास विभाग (RRNMU) को सेवा हेतु नवीन संयोजक आदेश सं. 308/2012/अन्वय/एम. मन्मथ सिंह/2012 संविधान 29/2012 का प्रकाशन किया गया है।

3. नवीन एवं ग्रामीण विकास विभाग (RRNMU) को सेवा हेतु नवीन संयोजक आदेश सं. 308/2012/अन्वय/एम. मन्मथ सिंह/2012 संविधान 29/2012 का प्रकाशन किया गया है। संयोजक आदेश सं. 308/2012/अन्वय/एम. मन्मथ सिंह/2012 संविधान 33/2012 के अन्तर्गत नवीन एवं ग्रामीण विकास विभाग (RRNMU) को सेवा हेतु नवीन संयोजक आदेश सं. 308/2012/अन्वय/एम. मन्मथ सिंह/2012 संविधान 29/2012 का प्रकाशन किया गया है। संयोजक आदेश सं. 308/2012/अन्वय/एम. मन्मथ सिंह/2012 संविधान 33/2012 के अन्तर्गत नवीन एवं ग्रामीण विकास विभाग (RRNMU) को सेवा हेतु नवीन संयोजक आदेश सं. 308/2012/अन्वय/एम. मन्मथ सिंह/2012 संविधान 29/2012 का प्रकाशन किया गया है। संयोजक आदेश सं. 308/2012/अन्वय/एम. मन्मथ सिंह/2012 संविधान 33/2012 के अन्तर्गत नवीन एवं ग्रामीण विकास विभाग (RRNMU) को सेवा हेतु नवीन संयोजक आदेश सं. 308/2012/अन्वय/एम. मन्मथ सिंह/2012 संविधान 29/2012 का प्रकाशन किया गया है।



Signature
[Name]
[Title]
[Department]

Location of Alloted Plot in Sector-24, NRDA for Pilot RNNMU

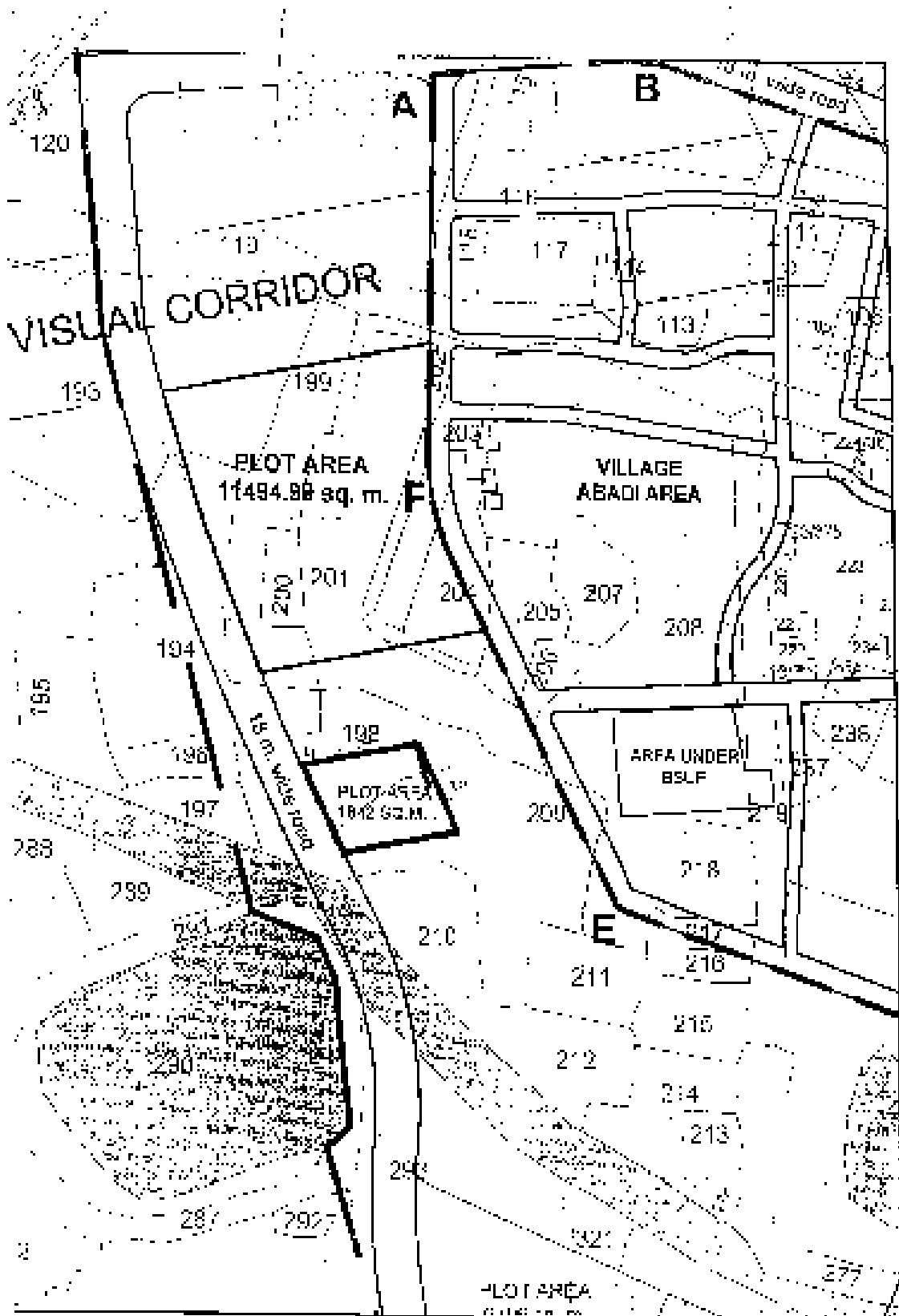

| | | |
|--|-------------------------|--------------|
| <p>PROPOSED SITE FOR OFFICE OF CHHATTISGARH RURAL ROAD DEVELOPMENT DEPARTMENT AT MAYA BOURUN</p> | <p>SCALE 1:2000</p> | <p>NORTH</p> |
|--|-------------------------|--------------|

List of Officials Consulted**CGRRDA**

Mr Sudhir Kumar Agarwal, CEO CGRRDA

Mr R K Dewangan, Superintending Engineer, ADB Cell, CGRRDA

Mr Mukesh Santoshi, Executive Engineer, ADB Cell, CGRRDA

Mr S K Tamrakar, Sub Engineer, PIU Raipur, CGRRDA

Mr A K Jain, Assistant Engineer, RCTRC, SIRD Nimora

PIC

Subhash C Nigam, Project Coordinator, PIC

Dr Deepak K Tripathi, Environmental Expert, PIC

III. RURAL CONNECTIVITY INVESTMENT PROGRAM - PROJECT 3: MADHYA PRADESH SOCIAL SAFEGUARDS COMPLIANCE – RRNMUs and RCTRC

A. Context and Purpose of the Report

1. The Government of India (GOI) launched “The Pradhan Mantri Gram Sadak Yojna (PMGSY) in 2000, with the objective to provide all-weather road connectivity to all rural habitations with a population of more than 500 persons in plains and 250 persons in hill states. This program is being implemented through the National Rural Road Development Authority (NRRDA) under the Ministry of Rural Development (MORD) at central level and through the State Rural Road Development Authority/Agencies (SRRDA) at state level.

2.

3. The Rural Connectivity Investment Program (RCIP) supports PMGSY through a multi-Project Financing Facility (MFF) that will construct or upgrade to all-weather standards 3,998 rural roads equivalent to 13,884 km, and connecting 5,238 habitations in the states of Assam, Chhattisgarh, Odisha, Madhya Pradesh and West Bengal (RCIP states). Investments in rural roads will improve connectivity, cut transport costs, and provide enabling infrastructure to areas currently with poor access to markets and urban towns, and thus contribute to growth and equity in the country’s largest sector.

4. RCIP is divided into three separate projects. Project 1 and Project 2 of US\$252 million, and \$US 275 million respectively, were approved in 2013 and are ongoing. Project 3 is expected to be approved at the end of 2015 with an estimated cost of USD 518.30 million.

5. Under RCIP Project 1 (Loan 2881-IND), each State is to establish one pilot RRNMU. Later during RCIP Project 3 (Tranche 3) approximately five additional RRNMUs (30 RRNMUs in total) are planned to be created. The RRNMUs shall be created based on the existing PIUs for rural roads and shall have staffing, equipment, and facilities adequate to provide effective management of the rural road network. The States shall ensure full RRNMU staffing and budget adequate for the full implementation of RRNMU tasks. The States shall prepare the design of RRNMU facilities. Similarly, under RCIP Project 1 (Loan 2881-IND) each State is to establish one RCTRC with the main objective to (i) conduct systematic training of engineers involved in the management of the rural road network, technicians, site supervisors, concerned staff of Panchayati Raj institutions, design consultants and contractors, and (ii) support a sustainable practice-oriented research on rural roads. The RCTRCs shall have staffing, equipment, and facilities adequate to provide high-quality and large scale training, both in house and with the use of external resource persons. Each State shall ensure full RCTRC staffing and budget adequate for the full implementation of RCTRC tasks. Like the RRNMUs, the States shall prepare the design of RCTRC facilities. The Madhya Pradesh Rural Road Development Authority (MPRRDA) is the implementing agency (IA) for the ADB funded subprojects in the state.

6. The Government is now planning to submit to ADB the third Periodic Finance Request (PFR) covering state of Madhya Pradesh. This report has been prepared to serve the purpose for compliance with ADB's social safeguards on involuntary resettlement and indigenous peoples during preparation of the RRNMUs and RCTRC subprojects in the state of Madhya Pradesh.

B. Status of RRNMUs and RCTRC in Madhya Pradesh

7. The proposed location of the RCTRC is at Bhopal, the State Head Quarter and the pilot RRNMU is proposed to be located at Jabalpur, adjacent to the existing PIU office. Both the buildings are proposed in land belonging to Deptt. of Panchayat and Rural Development, Govt. of Madhya Pradesh.

8. The proposed area under the two units are as under:

- **RCTRC:** Land allocated for construction of RCTRC building is 4593.95 sq m within the WALMI complex. Academic block, hostel building, guest house and director's residence have been planned to be constructed.
- **Pilot RRNMU :** Land allocated for construction of RRNMU building is 1800 sq m. Initially the land was placed for use by Rural Engineering Services (RES) division under Panchayat and Rural Development, Govt. of Madhya Pradesh. It has now been sanctioned by the Deptt. for RRNMU under MPRRDA.

C. Social Safeguards in the Project

9. The pilot RRNMU and RCTRC buildings are located in land owned and under possession of Panchayat and Rural Development Department, Govt. of Madhya Pradesh. Locations of additional RRNMUs are yet to be finalized. To mitigate the possible adverse impacts of the subprojects, the community participation framework (CPF) lists various types of impact categories and mitigation measures which would apply to the subprojects, based on the specific project impacts.

Mitigation Measures Matrix

| Impact Category | Mitigation Measures | Responsibility |
|----------------------------------|---|-------------------------------------|
| Loss of Agricultural Land | <ul style="list-style-type: none"> • Willing transfer of land by means of MOU • Advance notice to harvest standing crops • For vulnerable affected persons (APs), assistance/support by means of (a) alternate land sites provided by GP, or (b) cash assistance as per replacement cost⁹ by the Gram Panchayat (GP) to meet loss of land; and inclusion as beneficiaries in the existing poverty alleviation/livelihood restoration programs (see Annex of relevant state Community Participation Framework) • For land involving traditional and tenurial rights, the legal provisions applicable of the central and state governments pertaining to transfer of land will be followed. Existing customary rights of the tribal communities on various categories of land shall be taken into account during the process of land transfer. | GP, PIU and land revenue department |
| Loss of Structure | <ul style="list-style-type: none"> • Provision of alternate plot of land and structure of equivalent quality and value to be provided as per AP's choice, or cash assistance by GP to meet the loss of land and structure allowing the AP to purchase land and rebuild structure of equivalent standard • For loss of boundary walls and fences, willing transfer by means of MOU. In case voluntary donation of such structures are not possible, cash assistance as per replacement cost by GP to meet loss of such structures, or provision of materials and/or labor by GP to allow the AP to replace/rebuild the same • For vulnerable APs, inclusion as beneficiaries in the rural development (RD) programs/housing schemes (see Annex of relevant state Community Participation Framework) | GP, PIU and land revenue department |

⁹Replacement cost means the "cost" to replace the lost asset at current market value or its nearest equivalent, plus any transaction costs such as administrative charges, taxes, registration and titling costs allowing the individual / community to replace what is lost and their economic and social circumstances to be at least restored to the pre-project level.

| Impact Category | Mitigation Measures | Responsibility |
|--|---|-------------------------------------|
| Loss of Structure (Contd.) | <ul style="list-style-type: none"> For tenants, assistance to find alternative rental arrangements by GP, or cash assistance equivalent to advance payments made to the owner For squatters, provision of alternative relocation site, or cash assistance as per replacement cost, or provision of building material and/or labor by GP, or inclusion as beneficiaries in the RD programs/housing schemes. For land and structure involving traditional and tenurial rights, the legal provisions applicable of the central and state governments pertaining to transfer of land will be followed. Existing customary rights of the tribal communities on various categories of land shall be taken into account during the process of land transfer. | GP, PIU and land revenue department |
| Loss of livelihood | <ul style="list-style-type: none"> For vulnerable APs, inclusion as beneficiaries in the existing poverty alleviation /livelihood restoration programs (enumerated in Annex 9). In case of non inclusion in such programs, cash assistance to meet the loss of income during transitional phase and for income restoration. Assistance for asset creation¹⁰ by community and Gram Panchayat. | GP and PIU |
| Loss of Assets such as Trees, Well, and Ponds | <ul style="list-style-type: none"> Willing transfer of the asset by means of MOU. For vulnerable APs, assistance for the loss of these assets through inclusion as beneficiaries in the existing poverty alleviation/livelihood restoration programs (enumerated in Annex 9). In case of non inclusion in such programs, cash assistance by GP to meet the loss of assets and income. | GP, PIU and land revenue department |
| Loss of community owned assets such as temple, wells, ponds, grazing land etc | <ul style="list-style-type: none"> Relocation or construction of asset by GP with technical inputs from PIU Consultations with the concerned section of the community in case of grazing land, etc | GP, PIU and land revenue department |
| Temporary impacts during construction | <ul style="list-style-type: none"> Civil works contract conditions to include provisions to obligate the contractor to implement appropriate mitigation measures for the temporary impacts include disruption of normal traffic, increased noise levels, dust generation, and damage to adjacent parcel of land due to movement of heavy machinery to be included the Civil Works Contract | PIU |
| Other impacts not identified | Unforeseen impacts will be documented and mitigated based on the principles in this Framework. | |

¹⁰ Assistance for asset creation shall comprise of assistance for creation of cattle shed, shop, production unit or any other form of income generating asset that will enable the affected household in restoring their livelihood.

D. Approach and Methodology for Assessing Social Safeguards Compliance during preparation of the subprojects

10. The consultants visited both the sites for RCTRC building at WALMI complex in Bhopal and the pilot RRNMU site at Jabalpur and carried out consultations with the officials of MPRRDA, WALMI officials, Officers of PIU at Jabalpur and, Project Implementation Consultants (PIC). At the proposed academic block of RCTRC, there are some small structures of a 'sanitation demonstration project' used by WALMI for their training programmes. These structures will be demolished. The site proposed for the RRNMU is vacant and free of encumbrances. The consultants also carried out a desk review of the documents prepared for the project design, tender documents and the records of the land ownership



Structures of Sanitation Demonstration Project

11. The SRRDA with assistance from PIC conducted social safeguard screening of the proposed sites for the RCTRC and RRNMU. For the screening purpose a Social Safeguards Checklist was adopted that is presented in the appendices. As both the RCTRC and pilot RRNMU buildings are proposed in land owned and under possession of Deptt. of Panchayat and Rural Development, Govt. of Madhya Pradesh; the parent department of MPRRDA, there will be no need for monitoring of adverse impacts due to land requirement. However, PIC will provide monitoring support to the SRRDA for issues that might arise during execution of the project.



Site for RCTRC - Bhopal



Site for RRNMU – Jabalpur

E. Findings

1. Land Ownership

19. Panchayat and Rural Development Deptt., Govt. of Madhya Pradesh, parent department of MPRRDA (Implementing Agency of the project) is the owner of the land for the proposed RCTRC and RRNMU sites at WALMI complex, Bhopal and Jabalpur respectively.

12. Records of land ownership of RRNMU site at Jabalpur and departmental approval letter for locating the RCTRC in WALMI complex, Bhopal are annexed in the appendices.

2. Current Land use

a. Site for the Proposed RCTRC

13. The building is proposed within the premises of existing WALMI complex at Bhopal belonging to Panchayat and Rural Development Deptt., Govt. of Madhya Pradesh. Four separate land parcels within the complex has been identified for construction of the administrative block, staff quarters, guest house and trainees' hostel. Land parcels proposed for these activities are vacant and devoid of any structures except for the administrative centre where there are some small structures of the 'sanitation demonstration project' used by WALMI for their training programmes.

b. Site for the Pilot RRNMU Building

14. RRNMU is proposed on a plot of land adjacent to the existing PIU office at Jabalpur. At present the plot is vacant. This land parcel was under the possession of Rural Engineering Services (RES) division under Panchayat and Rural Development, Govt. of Madhya Pradesh. It has now been sanctioned by the Deptt. for constructing the RRNMU under MPRRDA.

3. Types of Loss and Affected Persons

15. The land parcels proposed for various activities under RCTRC and the pilot RRNMU are vacant plots without any structure and encroachment except for the administrative centre of the RCTRC where there are some small structures of the 'sanitation demonstration project' used by WALMI for their training programmes. The land parcels for RCTRC are within the boundary walls of the existing SIRD complex. Although the plot for the pilot RRNMU is under the possession of CGRRDA, it is yet to have a boundary wall.



Vacant Plot for Pilot RRNMU at Jabalpur

4. Consultation with Affected Persons

16. Consultants had consultations with senior officers of MPRRDA, WALMI, PIU Jabalpur, Project Architect and the PIC (list attached in appendices). MPRRDA has already applied for approval of the design and other municipal sanctions from respective city corporations. While the clearance has been already received for the Jabalpur site for pilot RRNMU, the same is in process for the RCTRC buildings from Bhopal Municipal Corporation. WALMI, MPRRDA and RES being under Panchayat and Rural Development Deptt., Govt. of Madhya Pradesh, there was full cooperation for the proposed subprojects.



5. Institutional Arrangements and Grievance Redress Mechanism

17. MPRRDA is the Implementing Agency. The land for both the RCTRC and RRNMU site belong to Panchayat and Rural Development Deptt., Govt. of Madhya Pradesh, the parent department of MPRRDA. There is no encroachment in any of the two sites. There is a government departmental procedure to address any grievances that might arise. The PIC is also in place to assist MPRRDA in addressing the safeguard issues in the project and monitoring of the related aspects.

F. Conclusion

18. The site visit and review of social assessment checklist prepared for the RCTRC and pilot RRNMU sites revealed that:

- a. Land is owned by Panchayat and Rural Development Deptt., Govt. of Madhya Pradesh, the parent department of the implementing agency (MPRRDA), for both the sites proposed for RCTRC at WALMI Complex and pilot RRNMU at Jabalpur.
- b. All the land parcels proposed for RCTRC and pilot RRNMU are vacant and free from encroachment except for the administrative centre of the RCTRC where there are some small structures of the 'sanitation demonstration project' used by WALMI for their training programmes. These structures will be demolished.
- c. There was consultation with senior officers of MPRRDA, WALMI, PIU Jabalpur, Project Architect and the PIC. While municipal clearance has been already received for the Jabalpur site for pilot RRNMU, the same is in process for the RCTRC buildings from Bhopal Municipal Corporation.
- d. MPRRDA has departmental procedure to address any grievances that might arise. PIC is in place to assist MPRRDA in monitoring of safeguard issues.

Appendix 1: Social Safeguards Checklist of RCTRC in Bhopal, MP

1. Where is the RCTRC located?

The land for RCTRC has been allotted in the campus of Water and land Management Institute (WALMI). WALMI is situated at the right bank of Kaliasot Dam at a distant of about 3 km from Kolar road in Bhopal

WALMI is under administrative control of Panchayat and Rural Development Department, Govt. of M.P. Special trainings are organized by WALMI for officers, Farmers, NGOs and elected members of PRIs on Rural Development Schemes, Water and Land Management etc.

Pls Refer Photographs in Annex - A

2. What are the land requirements of the building (area size requirements)?

The land allocated for construction of RCTRC building is 4593.95 sq m. Academic block, hostel building, guest house and directorate residence have been planned to be constructed. (Please Refer annex- B2 and B2.1)

3. What is the current land use of this area?

Four separate land parcels have been identified within WALMI for the academic block, staff quarters, hostels and guest house. All the land parcels are vacant except part of the land allotted for the academic block where there are some structures of the 'Demonstration Sanitation Project' used by WALMI for their training purposes.

4. Does some/all the land belong to the SRRDA? If all the land does, please provide documentation in annex and skip to question # 7

The land belongs to Panchayat and Rural Development Department, Govt. of MP. Both WALMI and MPRRDA are under Panchayat and Rural Development Department, Govt. of MP; hence land transfer is not required.

5. If the land does not belong to the SRRDA, is it government land? If yes, please describe share of land and size area belonging to government as well as procedures for SRRDA to acquire the government land.

Land belongs to the Panchayat and Rural Development Department, Govt. of MP which is the parental department of WALMI and MPRRDA.

6. Is some of the land private land? If yes describe the share and size of private land required and provide short brief census¹¹of affected households and survey of affected assets

No. there is no share of private land.

7. If the land is SRRDA's or belong to another public entity, are there any structures, agricultural activities belonging/conducted by squatters on the

¹¹Census should follow similar format as the one conducted for the Community Participation Framework

plot? If yes, please conduct brief census of affected households and survey of affected assets

Land belongs to Panchayat and Rural Development Department, Govt. of MP which is the parent department of MPRRDA. There are some structures of the 'Demonstration Sanitation Project' used by WALMI for their training purposes in one of the land parcels proposed for the administrative block of RCTRC. These will be demolished.

- 8. If answers to questions 6 and 7 are yes, please indicate mitigation measures as per the Mitigation Measure Matrix (Table 5.1 p. 2) of each state's Community Participation Framework (CPF). If any land/structures are donated, please describe participatory approach and provide substantiating documentation in annexes.**

The existing structures for the demonstration project will be demolished.

- 9. Additional comment (if any):**

None



EXISTING LAND USE OF THE LAND PARCELS PROPOSED FOR VARIOUS RCTRC COMPONENTS



EXISTING LAND USE OF THE LAND PARCELS PROPOSED FOR VARIOUS RCTRC COMPONENTS



STRUCTURES - SANITATION DEMONSTRATION PROJECT



FACILITIES WITHIN WALMI COMPLEX

| | |
|--|---|
|  <p>म.प्र. जल एवं भूमि प्रवर्धन संस्थान</p> | <p>राज्य विद्यालय, कलकत्ता-सीमा हाथ, जौहाना रोड, कोटा-202, विदेशीकरण नगर को, जमी, कोटा-202 फोन नं. 24222512, 24222513, 24222514</p> |
| <p>क्रमांक-वाली/प्र.प्र.प्रा.सं/2012/380</p> | <p>गोपाल दिनांक 01/07/2014</p> |
| <p>प्रति, मुख्य का/जनन अधिकारी, मंत्रालय, कृषक विकास प्राधिकरण, गंधारवा मण्डल, गोपाल विभाग</p> | |
| <p>विषय: Rural Road Connectivity Resilience & Training Center (RRC/RTC) के बली परिवार में एड एना के संदर्भ में।</p> | |
| <p>संदर्भ: 1. अन्वयता पत्र क्र.प्रा.प्रा.सं/वाली/सी 29/12 दि. 25/01/2012 2. संस्थान का एड क्र. अन्व. 113/वेकल/फार्म/2012-13/18/791, दि. 08.09.2012</p> | |
| <p>उपरोक्त विषयवर्ती, म.प्र.प्रा.प्रा.सं/वाली/सी 29/12 दि. 25/01/2012 के संदर्भ में एडीओ को संस्थान के शोध करीब में, केन्द्र स्थापना आदि प्रस्तावित है। इस संदर्भ में एडीओ से पूर्व में नार्मलिंग किया गया है। अन्वयतापत्र के अन्वय अधिकारी को उक्त आदेश तथा एना पर एना के निर्देशों द्वारा वास्तविकता को विहित किया गया है।</p> <p>म.प्र.प्रा.प्रा.सं/वाली/सी 29/12 दि. 25/01/2012 के संदर्भ में एडीओ को संस्थान के शोध करीब में, केन्द्र स्थापना आदि प्रस्तावित है। इस संदर्भ में एडीओ से पूर्व में नार्मलिंग किया गया है। अन्वयतापत्र के अन्वय अधिकारी को उक्त आदेश तथा एना पर एना के निर्देशों द्वारा वास्तविकता को विहित किया गया है।</p> | |
| <p>म.प्र.प्रा.प्रा.सं/वाली/सी 29/12 दि. 25/01/2012 के संदर्भ में एडीओ को संस्थान के शोध करीब में, केन्द्र स्थापना आदि प्रस्तावित है। इस संदर्भ में एडीओ से पूर्व में नार्मलिंग किया गया है। अन्वयतापत्र के अन्वय अधिकारी को उक्त आदेश तथा एना पर एना के निर्देशों द्वारा वास्तविकता को विहित किया गया है।</p> | |
| <p>संस्थापक निदेशक, म.प्र.प्रा.प्रा.सं/वाली/सी 29/12 दि. 25/01/2012</p> | |
| <p>18 JUN 2014</p> | <p>संस्थापक निदेशक, म.प्र.प्रा.प्रा.सं/वाली/सी 29/12 दि. 25/01/2012</p> |

Annexure – RCTRC B 2

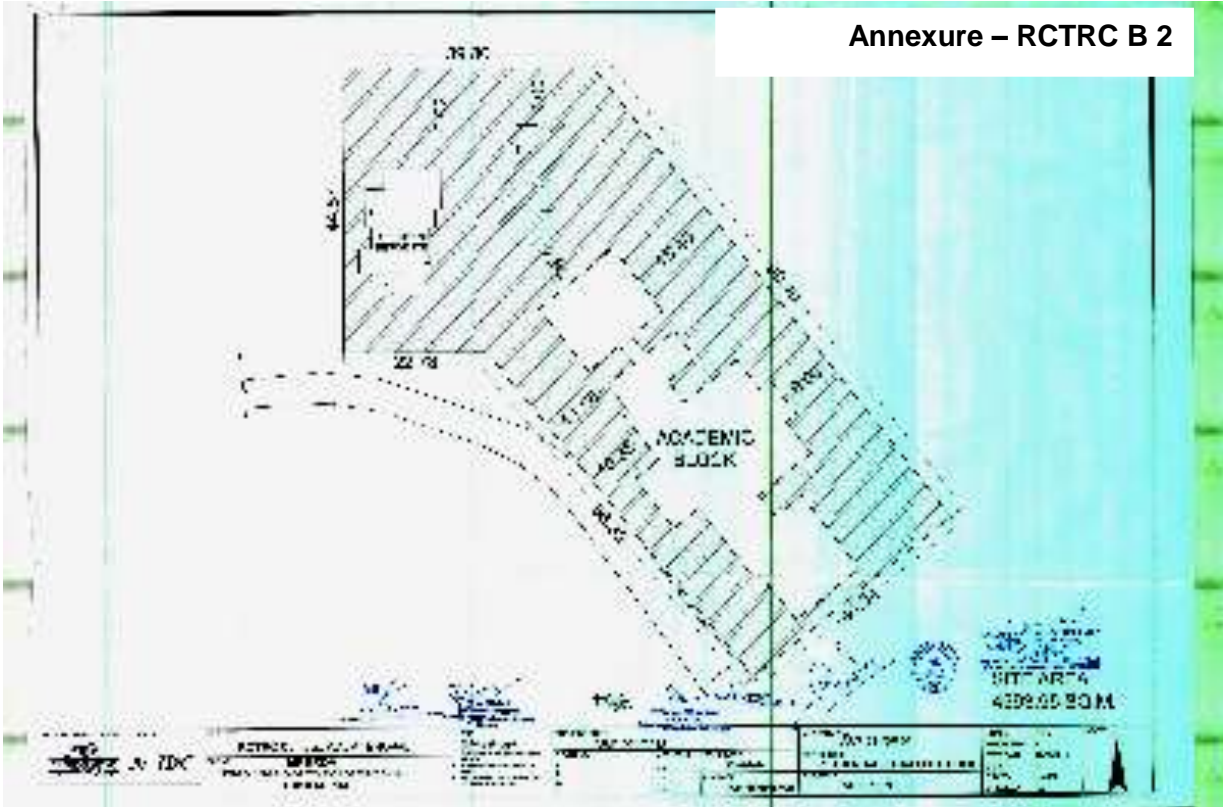

Annexure – RCTRC B 2.1

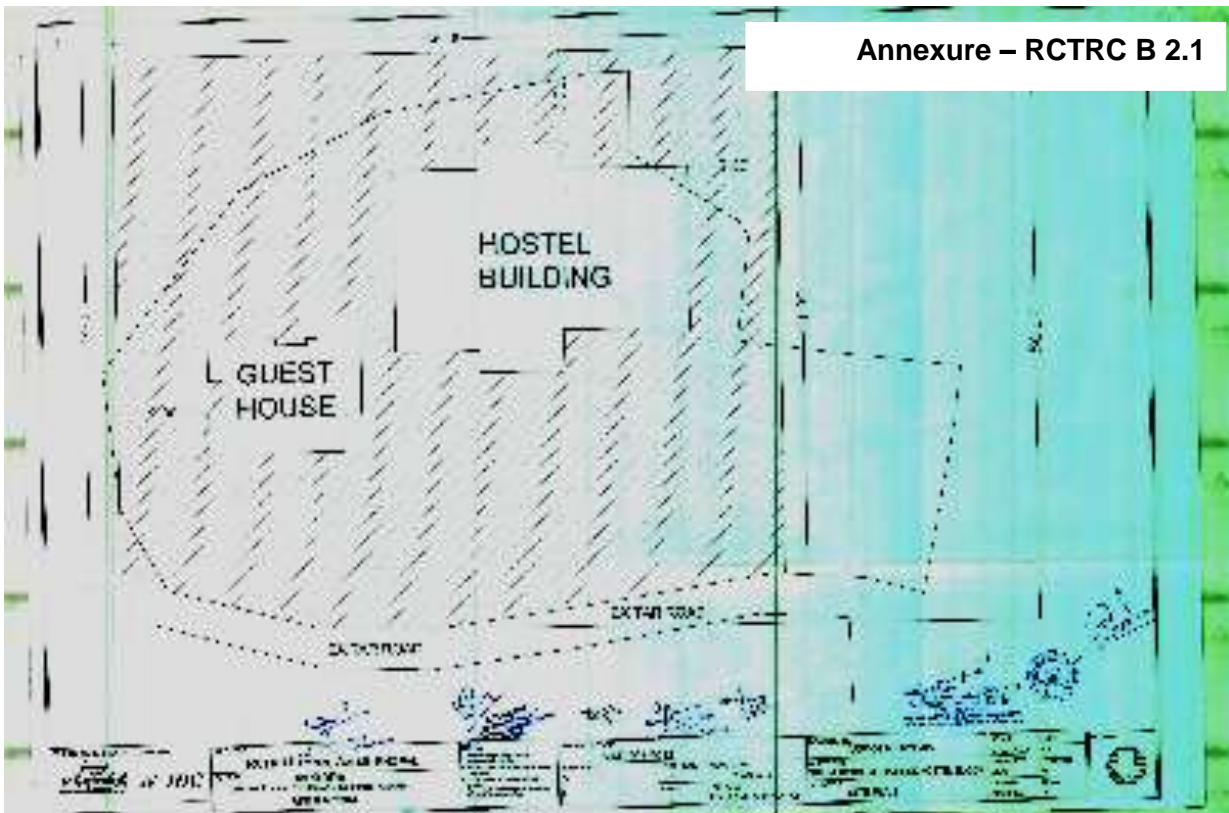

Appendix 2: Social Safeguards Checklist for Pilot RRNMU at Jabalpur, MP

1. Where is the pilot RRNMU located?

The land for pilot RRNMU is proposed next to the existing MPRRDA PIU office at Jabalpur. Pls Refer Photographs in Annex – A

2. What are the land requirements of the building (area size requirements)?

The land allocated for construction of RRNMU building is 1800 sq m.

3. What is the current land use of this area?

Presently the land is lying vacant. Pls Refer Photographs in Annex – A

4. Does some/all the land belong to the SRRDA? If all the land does, please provide documentation in annex and skip to question # 7

No. The land originally belonged to RES but it has been transferred to MPRRDA for constructing the RRNMU building.

5. If the land does not belong to the SRRDA, is it government land? If yes, please describe share of land and size area belonging to government as well as procedures for SRRDA to acquire the government land.

Yes, it is a Government Land. MPRRDA has already taken possession of the demarcated land on dated 20.01.88-89. The possession letter has been issued by RES for the land. Pls refer annex- B-I, B-II, B-III, B-IV

6. Is some of the land private land? If yes describe the share and size of private land required and provide short brief census¹²of affected households and survey of affected assets

No. There is no share of private land.

7. If the land is SRRDA's or belong to another public entity, are there any structures, agricultural activities belonging/conducted by squatters on the plot? If yes, please conduct brief census of affected households and survey of affected assets

There is no structure on the proposed land and it is not being used for any agriculture activity. There are no squatters on the plot

8. If answers to questions 6 and 7 are yes, please indicate mitigation measures as per the Mitigation Measure Matrix (Table 5.1 p. 2) of each state's Community Participation Framework (CPF). If any land/structures are donated, please describe participatory approach and provide substantiating documentation in annexes.

Not applicable.

9. Additional comment (if any):

Nil

¹²Census should follow similar format as the one conducted for the Community Participation Framework

Annexure-RRNMU - A

Existing Site Condition of Proposed Plot for Pilot RRNMU at Jabalpur



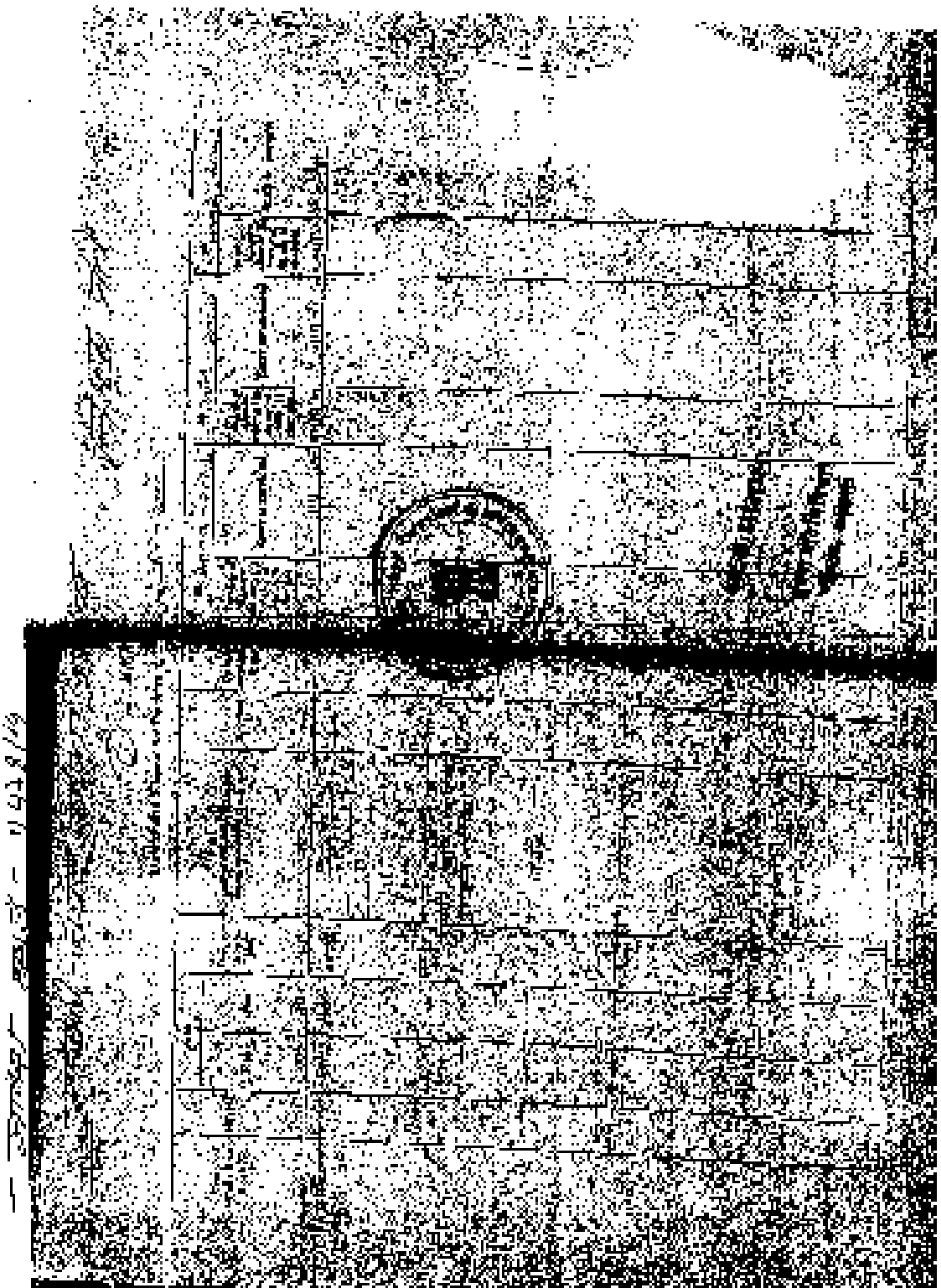

Annexure-RRNMU – B4

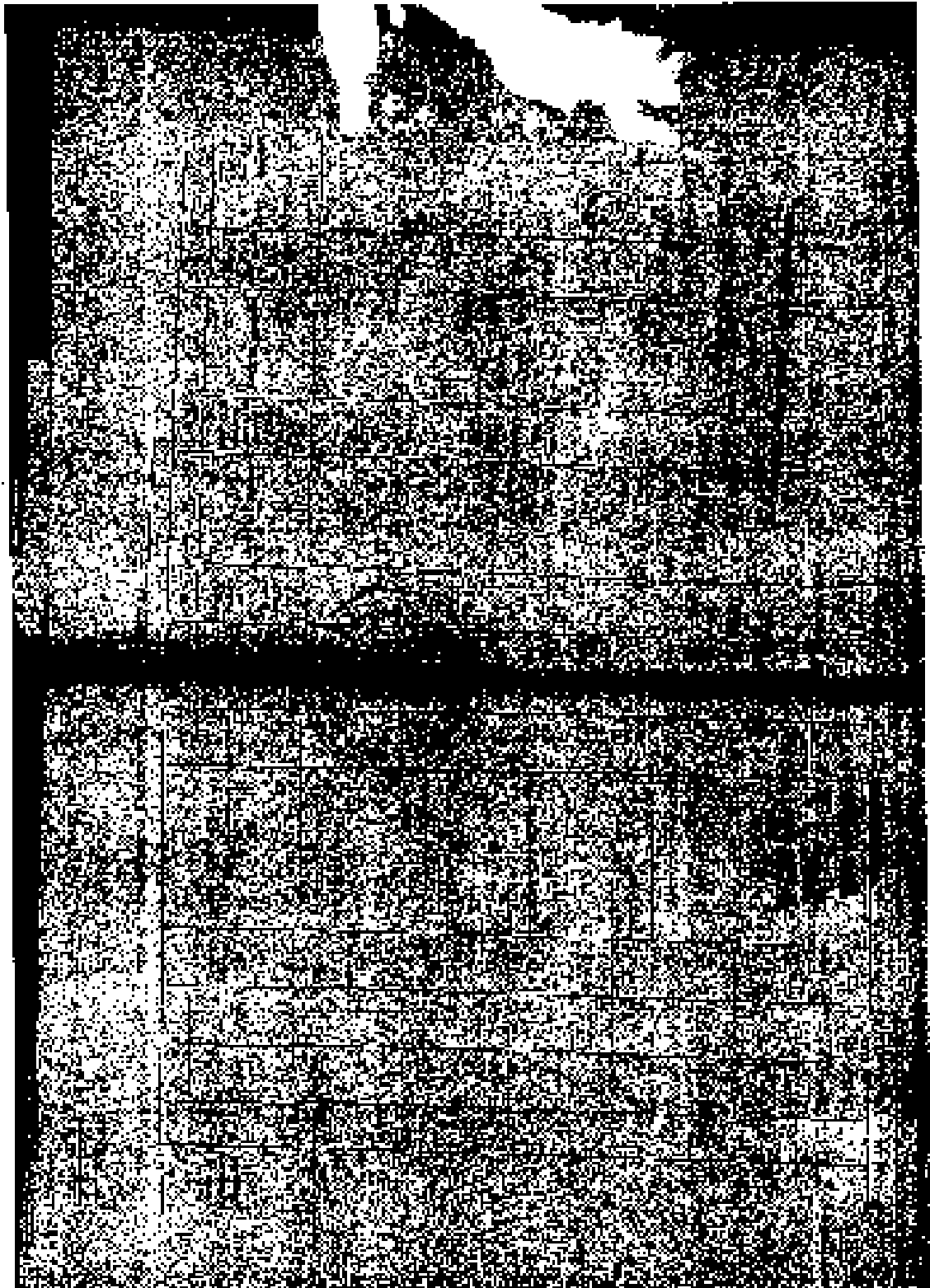

List of Officials Consulted

MPRRDA

Mr A D Kapaley, CGM I, MP RRDA
Mr H P Shivhare, CGM, Director, RCTRC, MP RRDA
Mr A K Nagaria, GMT -3, MP RRDA
Mr Harish Sharma, AM, MP RRDA

WALMI

Mr Rajput, Technical Assistant WALMI
Mr Mahesh Khare, Administrative Assistant, WALMI

PIC

Subhash C Nigam, Project Coordinator, PIC
Dr Deepak K Tripathi, Environmental Expert, PIC
Ms Bhavana Nagar, Social Expert, PIC

IV. RURAL CONNECTIVITY INVESTMENT PROGRAM – PROJECT 3: ODISHA SOCIAL SAFEGUARDS COMPLIANCE – RRNMUs and RCTRC

A. Context and Purpose of the Report

1. The Government of India (GOI) launched “The Pradhan Mantri Gram Sadak Yojna (PMGSY) in 2000, with the objective to provide all-weather road connectivity to all rural habitations with a population of more than 500 persons in plains and 250 persons in hill states. This program is being implemented through the National Rural Road Development Authority (NRRDA) under the Ministry of Rural Development (MORD) at central level and through the State Rural Road Development Authority/Agencies (SRRDA) at state level.

2. The Rural Connectivity Investment Program (RCIP) supports PMGSY through a multi-Project Financing Facility (MFF) that will construct or upgrade to all-weather standards 3,998 rural roads equivalent to 13,884 km, and connecting 5,238 habitations in the states of Assam, Chhattisgarh, Odisha, Madhya Pradesh and West Bengal (RCIP states). Investments in rural roads will improve connectivity, cut transport costs, and provide enabling infrastructure to areas currently with poor access to markets and urban towns, and thus contribute to growth and equity in the country’s largest sector.

3. RCIP is divided into three separate projects. Project 1 and Project 2 of US\$252 million, and \$US 275 million respectively, were approved in 2013 and are ongoing. Project 3 is expected to be approved at the end of 2015 with an estimated cost of USD 518.30 million.

4. Under RCIP Project 1 (Loan 2881-IND), each State is to establish one pilot RRNMU. Later during RCIP Project 3 (Tranche 3) approximately five additional RRNMUs (30 RRNMUs in total) are planned to be created. The RRNMUs shall be created based on the existing PIUs for rural roads and shall have staffing, equipment, and facilities adequate to provide effective management of the rural road network. The States shall ensure full RRNMU staffing and budget adequate for the full implementation of RRNMU tasks. The States shall prepare the design of RRNMU facilities. Similarly, under RCIP Project 1 (Loan 2881-IND) each State is to establish one RCTRC with the main objective to (i) conduct systematic training of engineers involved in the management of the rural road network, technicians, site supervisors, concerned staff of Panchayati Raj institutions, design consultants and contractors, and (ii) support a sustainable practice-oriented research on rural roads. The RCTRCs shall have staffing, equipment, and facilities adequate to provide high-quality and large scale training, both in house and with the use of external resource persons. Each State shall ensure full RCTRC staffing and budget adequate for the full implementation of RCTRC tasks. Like the RRNMUs, the States shall prepare the design of RCTRC facilities. The Odisha State Rural Road Agency (OSRRA) is the implementing agency (IA) for the ADB funded subprojects in the state.

5. The Government is now planning to submit to ADB the third Periodic Finance Request (PFR) covering state of Odisha. This report has been prepared to serve the purpose for compliance with ADB's social safeguards on involuntary resettlement and indigenous peoples during preparation of the RRNMUs and RCTRC subprojects in the state of Odisha.

B. Status of RRNMUs and RCTRC in Odisha

6. The proposed location of the pilot RRNMU is at Angul in Angul district and the RCTRC is proposed to be located at Bhubaneswar, the State Head Quarter. Both the buildings are proposed in land belonging to Rural Development Department, Government of Odisha, parent department of OSRRA, the IA.

7. The proposed area under the two units are as under:

- **RCTRC:** A total of 2226.56 sqm has been identified for the construction of the new building. The built-up area of the building is 2114.28 sqm.
- **Pilot RRNMU:** A total of 1659.11 sqm has been identified for the construction of the new building. The built up area of the building is 1391.8 sqm.

C. Social Safeguards in the Project

8. The pilot RRNMU and RCTRC buildings are located in land owned and under possession of Rural Development Department, Government of Odisha. Locations of additional RRNMUs are yet to be finalized. To mitigate the possible adverse impacts of the subprojects, the community participation framework (CPF) lists various types of impact categories and mitigation measures which would apply to the subprojects, based on the specific project impacts.

Mitigation Measures Matrix

| Impact Category | Mitigation Measures | Responsibility |
|---------------------------|--|-------------------------------------|
| Loss of Agricultural Land | <ul style="list-style-type: none"> • Willing transfer of land by means of MOU • Advance notice to harvest standing crops • For vulnerable affected persons (APs), assistance/support by means of (a) alternate land sites provided by GP, or (b) cash assistance as per replacement cost¹³ by the Gram Panchayat (GP) to meet loss of land; and inclusion as beneficiaries in the existing poverty alleviation/livelihood restoration programs (see Annex of relevant state Community Participation Framework) • For land involving traditional and tenurial rights, the legal provisions applicable of the central and state governments pertaining to transfer of land will be followed. Existing customary rights of the tribal communities on various categories of land shall be taken into account during the process of land transfer. | GP, PIU and land revenue department |
| Loss of Structure | <ul style="list-style-type: none"> • Provision of alternate plot of land and structure of equivalent quality and value to be provided as per AP's choice, or cash assistance by GP to meet the loss of land and structure allowing the AP to purchase land & rebuild structure of equivalent standard • For loss of boundary walls and fences, willing transfer by means of MOU. In case voluntary donation of such structures are not possible, cash assistance as per replacement cost by GP to meet loss of such structures, or provision of materials and/or labor by GP to allow the AP to replace/rebuild the same • For vulnerable APs, inclusion as beneficiaries in the rural development (RD) programs/housing schemes (see Annex of relevant state Community Participation Framework) • For tenants, assistance to find alternative rental arrangements by GP, or cash assistance equivalent to advance payments made to the owner | GP, PIU and land revenue department |

¹³Replacement cost means the "cost" to replace the lost asset at current market value or its nearest equivalent, plus any transaction costs such as administrative charges, taxes, registration and titling costs allowing the individual / community to replace what is lost and their economic and social circumstances to be at least restored to the pre-project level.

| Impact Category | Mitigation Measures | Responsibility |
|---|--|-------------------------------------|
| Loss of Structure (Contd.) | <ul style="list-style-type: none"> For squatters, provision of alternative relocation site, or cash assistance as per replacement cost, or provision of building material and/or labor by GP, or inclusion as beneficiaries in the RD programs/housing schemes. For land and structure involving traditional and tenurial rights, the legal provisions applicable of the central and state governments pertaining to transfer of land will be followed. Existing customary rights of the tribal communities on various categories of land shall be taken into account during the process of land transfer. | GP, PIU and land revenue department |
| Loss of livelihood | <ul style="list-style-type: none"> For vulnerable APs, inclusion as beneficiaries in the existing poverty alleviation /livelihood restoration programs (enumerated in Annex 9). In case of non inclusion in such programs, cash assistance to meet the loss of income during transitional phase and for income restoration. Assistance for asset creation¹⁴ by community and Gram Panchayat. | GP and PIU |
| Loss of Assets such as Trees, Well, and Ponds | <ul style="list-style-type: none"> Willing transfer of the asset by means of MOU. For vulnerable APs, assistance for the loss of these assets through inclusion as beneficiaries in the existing poverty alleviation/livelihood restoration programs (enumerated in Annex 9). In case of non inclusion in such programs, cash assistance by GP to meet the loss of assets and income. | GP, PIU and land revenue department |
| Loss of community owned assets such as temple, wells, ponds, grazing land etc | <ul style="list-style-type: none"> Relocation or construction of asset by GP with technical inputs from PIU Consultations with the concerned section of the community in case of grazing land, etc | GP, PIU and land revenue department |
| Temporary impacts during construction | <ul style="list-style-type: none"> Civil works contract conditions to include provisions to obligate the contractor to implement appropriate mitigation measures for the temporary impacts include disruption of normal traffic, increased noise levels, dust generation, and damage to adjacent parcel of land due to movement of heavy machinery to be included the Civil Works Contract | PIU |
| Other impacts not identified | Unforeseen impacts will be documented and mitigated based on the principles in this Framework. | |

D. Approach and Methodology for Assessing Social Safeguards Compliance during preparation of the subprojects

9. The consultants visited both the sites for RCTRC building at Bhubaneswar and the pilot RRNMU site at Hakimpada, Angul and carried out consultations with the officials of OSRRA at Bhubaneswar, PIU, Angul and Project Implementation Consultants (PIC). The site proposed for the RCTRC has some structure for the watchman and temporary sheds for storage of materials. The pilot RRNMU site is vacant and free from any encumbrances. The consultants also carried out a desk review of the documents prepared for the project design,

¹⁴ Assistance for asset creation shall comprise of assistance for creation of cattle shed, shop, production unit or any other form of income generating asset that will enable the affected household in restoring their livelihood.

tender documents and the departmental orders for locating the proposed centres at the designated locations.

10. The SRRDA with assistance from PIC conducted social safeguard screening of the proposed sites for the RCTRC and RRNMU. For the screening purpose a Social Safeguards Checklist was adopted that is presented in the appendices. As both the RCTRC and pilot RRNMU buildings are proposed in land owned and under possession of Rural Development Department, Govt. of Odisha; the parent department of OSRRA, there will be no need for monitoring of adverse impacts due to land requirement. However, PIC will provide monitoring support to the SRRDA for issues that might arise during execution of the project.



Site for RCTRC - Bhubaneswar



Site for RRNMU – Hakimpada, Angul

E. Findings

1. Land Ownership

11. Rural Development Department, Government of Odisha, parent department of OSRRA, the Implementing Agency of the project is the owner of the land for the proposed RCTRC and RRNMU sites at Bhubaneswar and Angul respectively.

12. Written records of land ownership and letters confirming allocation of land (Refer appendices) for the RCTRC and pilot RRNMU were verified.

2. Current Land use

a. Site for the Proposed RCTRC

13. The integrated RCTRC building having academic facilities, guest house and hostel for the trainees is proposed at the plot of land near Khandagiri in Bhubaneswar. The land parcel is located between the existing SE office of RWSS and the RWPH Division office. The plot is presently used for parking of department vehicles and storage of materials in some temporary sheds. Besides the storage, shed, there is a tinned roof room for the watch man. The high tension power line crosses the site at one of its corners,



however, it is well away from the proposed building lines. There are also some trees of local variety within the site.

b. Site for the Pilot RRNMU Building

14. Pilot RRNMU is proposed on a plot of land adjacent to the SE, Rural Works office close to PIU Angul. The plot is well connected from the main road and opens from two sides. It is vacant and free of any encumbrances. There are some bushes and shrubs but no trees at the proposed site.



3. Types of Loss and Affected Persons

a. Site for the RCTRC at Bhubaneswar

15. The proposed RCTRC complex will affect existing watchman shed and the tempray shed used for storage of materials. The site also has a shallow hand pump drawing ground water for general use. Some trees of local variety are also within the site. A few of these trees towards the boundary of the plot will be saved as the proposed building is located in the centre of the plot as per the layout plan.

b. Site for the Pilot RRNMU Building at Angul

16. Proposed RRNMU site at Angul is vacant and free of encroachment. It also does not have any tree within the plot.

4. Consultation with Affected Persons

17. Consultants had consultations with senior officers of SRRDA, Angul PIU and the PIC (list attached in appendices). Applications for municipal approvals for both the proposed buildings are in process with Bhubaneswar and Angul Municipalities respectively. These will be completed before award of the work contracts.



Consultation at RCTRC Site



Consultation at RRNMU Site

5. Institutional Arrangements and Grievance Redress Mechanism

18. OSRRA is the Implementing Agency. The land for both the RCTRC and RRNMU site belong to Rural Development Deptt., Govt. of Odisha; the parent department of OSRRA. There is no encroachment in any of the two sites. There is a government departmental procedure to address any grievances that might arise. The PIC is also in place to assist OSSRA in addressing the safeguard issues in the project and monitoring of the related aspects.

F. Conclusion

19. The site visit and review of social assessment checklist prepared for the RCTRC and pilot RRNMU sites revealed that:

- a. Land is owned and under possession of Rural Development Deptt., Govt. of Odisha, the parent department of the implementing agency (OSSRA), for both the sites proposed for RCTRC near Khandagiri in Bhubaneswar and pilot RRNMU at Angul.
- b. Both the plots proposed for RCTRC and pilot RRNMU are vacant and free from encroachment except for the RCTRC where there are some small structures including temporary sheds for the watchman and storage of materials. These structures will be demolished.
- c. There was consultation with senior officers of OSSRA, PIU Angul and the PIC. Applications for municipal approvals for both the proposed buildings are in process with Bhubaneswar and Angul Municipalities. These will be completed before award of the work contracts..
- d. OSSRA has departmental procedure to address any grievances that might arise. PIC is in place to assist OSSRA in monitoring of safeguard issues.

Appendix 1: Social Safeguards Checklist for RCTRC at Bhubaneswar, Odisha

1. Where is the RCTRC located?

Proposed location of RCTRC is at Plot No 1214 (Part) Near Tapaban High School and KB Art College, Khandagiri, Bhubaneswar

2. What are the land requirements of the building (area size requirements)?

Total Land – 2226.56 sqm
Built up Area-2114.28 sqm (Details attached in Annex 1)

3. What is the current land use of this area?

The area is having boundary on all sides, currently used for storage of used vehicles and other sundry materials of RD department, Govt. of Odisha. As per revenue classification, the area falls under uncultivable waste land but as per municipal corporation notification the plot comes under area demarcated for commercial use.

4. Does some/all the land belong to the SRRDA? If all the land does, please provide documentation in annex and skip to question # 7

Yes. The land, as per revenue records, belongs to Govt. of Odisha and under the use of RD Department, parent department of OSSRA. The land document is attached in annex 2

5. If the land does not belong to the SRRDA, is it government land? If yes, please describe share of land and size area belonging to government as well as procedures for SRRDA to acquire the government land.

Not Applicable.

6. Is some of the land private land? If yes describe the share and size of private land required and provide short brief census¹⁵of affected households and survey of affected assets

Not applicable since no private land is to be acquired whatsoever

7. If the land is SRRDA's or belong to another public entity, are there any structures, agricultural activities belonging/conducted by squatters on the plot? If yes, please conduct brief census of affected households and survey of affected assets

There are some temporary sheds for storage of used materials and .for the watchman.

8. If answers to questions 6 and 7 are yes, please indicate mitigation measures as per the Mitigation Measure Matrix (Table 5.1 p. 2) of each state's Community Participation Framework (CPF). If any land/structures are donated, please describe participatory approach and provide substantiating documentation in annexes.

¹⁵Census should follow similar format as the one conducted for the Community Participation Framework

Not Applicable.

9. Additional comment (if any):

There is a good connectivity to the proposed site of RCTRC from NH 5. The area has other important institutions like school, college and markets in the nearby area. The proposed site is suitable for construction of RCTRC

Existing Site Conditions of the Proposed RCTRC Site, Bhubaneswar



Annexure-02

1

1

ଖତିୟାନ

ନୌଜା : ବାଟିଡିଆ

ତହସିଲ : ବୁବନେଶ୍ୱର

ଥାନା : ଚନ୍ଦଳ

ତହସିଲ ନମ୍ବର : ..

ଥାନା ନମ୍ବର : 50

ଜିଲ୍ଲା : ଖୋର୍ଦ୍ଧା

| | | | | | | |
|--|------|---------------------------|------|--|-----|-----------------------------------|
| କମିସନର ନାମ ଓ ଖୋଟାଟ ନାମ ଖତିୟାନର କ୍ରମିକ ନମ୍ବର | | ଓଡିଶା ପରକାର ଖୋଟାଟ ନମ୍ବର 1 | | | | |
| 1) ଖତିୟାନର କ୍ରମିକ ନମ୍ବର | | 443 | | | | |
| 2) ପ୍ରକାର ନାମ, ପିତାଙ୍କ ନାମ, ଜାତି ଓ ବାସସ୍ଥାନ | | ଅନାବାଦୀ : | | | | |
| 3) ସ୍ୱରୂପ | | | | | | |
| 4) ଚେରୁ | କଳକର | ଖଜଣା | ସେସ୍ | ନିସ୍ତାର ସେସ୍ ଓ ଅନ୍ୟାନ୍ୟ ସେସ୍ ଯଦି କିଛି ଥାଏ | ମୋଟ | 5) କ୍ରମବର୍ଦ୍ଧନଶୀଳ ଖଜଣାର ବିବରଣୀ |
| | | | | | | |
| 6) ବିଶେଷ ଅନୁପନ୍ନ ଯଦି କିଛି ଥାଏ | | | | | | |
| BLANK SPACE FOR STAMPING | | | | | | |
| ଅନ୍ତିମ ପ୍ରକାଶନ ତାରିଖ - 12/03/1962 ଖଜଣା ଆର୍ଯ୍ୟ ତାରିଖ - | | | | | | |

| | | | | | |
|-----------------|--------------|--|----|-----|--|
| | | | | | ମୁଦାବତ ମୁତ ନମ୍ବର 1207 ସମସ୍ତ ଏଠା 100 ଖାଲିକ ଦଖଲ ଖାତା 326/13 ରେ । |
| 1212 | ପୁରାତନ ପଡ଼ିତ | | 1 | 706 | ଦଖଲ ଖାଲିକ କେସ ନମ୍ବର 1127/70 ଦୁଇମ ମୁଦାବତ ମୁତ ନମ୍ବର 1212 ସମସ୍ତ ଏଠା 424 ଖାଲିକ ଦଖଲ ଖାତା 326/8 ରେ । |
| 1214 | ପୁରାତନ ପଡ଼ିତ | | 14 | 710 | |
| 1215 | ପୁରାତନ ପଡ଼ିତ | | 30 | 255 | ପଡ଼ିଆ ନଥି ନମ୍ବର 1181 , 1087 , 51/5253 , 1081 , 51/52. 53, 123 , 1155 . 1259, 193, 1085 , 51/52. 53, 467 , 1086 , 1082 , 1083 , 1206 , 1089 , 1209 , 1084 , 1088 , 51/52. 53 , 51/52.53 , 1090 , 1283 , 12/65. 66, 1091 , 1156 , 1120 , 1215 , 1220 |

Appendix 2: Social Safeguards Checklist for Pilot RRNMU at Angul, Odisha

1. Where is the RRNMU located?

Proposed location of Pilot RRNMU is at Plot No 1570 (P) Near Office of the SE, RW at Hakimpada, Angul

2. What are the land requirements of the building (area size requirements)?

Total Land – 1659.11 sqm
Built up Area-1391.8 sqm (Details attached in Annex 1)

3. What is the current land use of this area?

The area is having boundary on all sides, currently under the possession of Rural Development Department, Govt. of Odisha. As per revenue classification, the area falls under uncultivable waste land but as per municipality notification the plot comes under institutional area.

4. Does some/all the land belong to the SRRDA? If all the land does, please provide documentation in annex and skip to question # 7

Yes. The land, as per revenue records, belongs to Govt. of Odisha and by mutation process allotted to EE, RW Division, Angul as the representative of SRRDA which is constituted by the RD Department, Govt. of Odisha. The land document is attached in annex 2

5. If the land does not belong to the SRRDA, is it government land? If yes, please describe share of land and size area belonging to government as well as procedures for SRRDA to acquire the government land.

Not Applicable.

6. Is some of the land private land? If yes describe the share and size of private land required and provide short brief census¹⁶of affected households and survey of affected assets

Not Applicable since no private land is to be acquired whatsoever

7. If the land is SRRDA's or belong to another public entity, are there any structures, agricultural activities belonging/conducted by squatters on the plot? If yes, please conduct brief census of affected households and survey of affected assets

No. There are no structures or any encroachment by squatters at the proposed site.

8. If answers to questions 6 and 7 are yes, please indicate mitigation measures as per the Mitigation Measure Matrix (Table 5.1 p. 2) of each state's Community Participation Framework (CPF). If any land/structures are donated, please

¹⁶Census should follow similar format as the one conducted for the Community Participation Framework

describe participatory approach and provide substantiating documentation in annexes.

Not Applicable.

9. Additional comment (if any):

There is a good connectivity to the proposed site of RRNMU as it is centrally located in Angul town. The area has other important institutions- Circuit house on North, Aurovila Hotel on South, SE, RW office on East and Satkosia Wild Life Project office on the West. The proposed site is suitable for construction of RRNMU.

Existing Site Condition of Pilot RRNMU at Angul



Details of Land Ownership – Site for Pilot RRNMU

Annexure-01

PROCEEDINGS OF THE SITE SELECTION COMMITTEE MEETING HELD ON 23.06.2014 AT 10.00 A.M. IN THE OFFICE CHAMBER OF ADDL. DISTRICT MAGISTRATE, ANGUL FOR SELECTION OF SITE IN FAVOUR OF RURAL DEVELOPMENT DEPARTMENT FOR CONSTRUCTION OF RURAL ROAD NETWORK MAINTENANCE UNIT (RRNMU) IN MOUZA ANGUL TOWN.

The meeting was held under the Chairmanship of Sri Susanta Kumar Barik, OAS (S), Addl. District Magistrate, Angul. The following members were present in the meeting.

- 1) Sub-Collector, Angul
- 2) Tahasildar, Angul
- 3) Executive Engineer, R&B, Angul
- 4) Secretary, TAMDA, Angul
- 5) C.D.M.O., Angul
- 6) Asst. Engineer, PHD, Angul
- 7) Executive Engineer, RWD, Angul.

Tahasildar, Angul has submitted the Land Plan and Land Schedule as detailed below after visiting the site for construction of Rural Road Network Maintenance Unit (RRNMU) in Mouza Angul Town for alienation in favour of Rural Development Department. The committee members discussed on the proposal submitted by the Tahasildar, Angul.

The Committee members have also visited the site and accepted the proposal unanimously.

The selection will remain valid for one year only. The land schedule of the proposed site is as follows:

DESCRIPTION OF LAND

| Mouza | Khata No. | Plot No. | Kisam | Area in Acre | Remarks |
|------------|------------|----------|----------------|--------------|---------|
| Angul Town | 1 (Sarkar) | 1570 (P) | Puratan Patita | Ac.0.40 | |
| TOTAL | | | | Ac.0.40 | |

Tahasildar, Angul.
TAHASILDAR
ANGUL

Executive Engineer,
R&B, Angul.

Sub-Collector, Angul.

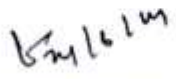
CDMO, Angul
for
Chief District Medical Officer
(Govt of Odisha), Angul

Addl. District Magistrate,
Angul.

Executive Engineer,
R.W. Division, Angul.

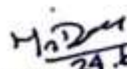
Asst. Engineer
P.H. Sub-Division, Angul

Secretary,
TAMDA, Angul.

ଲ୍ୟାଣ୍ଡ ସିଡ୍ୟୁଲ
 ମୌଜା-ଅନୁଗୋଳ ଟାଉନ. ଧାନା-ଅନୁଗୋଳ. ନଂ- ତହସିଲ-ଅନୁଗୋଳ. ଜିଲ୍ଲା-ଅନୁଗୋଳ

| ଅତିୟାନ ମୁତାବକ | | | | ଦରଖାସ୍ତ ମୁତାବକ | | | | | |
|---------------|--------------------|-------|-------------|----------------|---------|--|-------|-------------|------|
| ଖାତା ନଂ | ଭସତ ଜା ନାମ | ପୂ.ନଂ | କିସମ | ରଜତା | ଖାତା ନଂ | ଭସତ ଜା ନାମ | ପୂ.ନଂ | କିସମ | ରଜତା |
| ୧ | ଅଧିକାରୀ ପୁରୁ କାନ୍ତ | ୧୫୫୦ | ପୂର୍ଣ୍ଣାଙ୍ଗ | ୩.୦୧ | କୂଳ | ନିର୍ଦ୍ଦେଶ ମାନ୍ୟତା, ପ୍ରାଥମିକ ପ୍ରତିଷ୍ଠାନ | ୧୫୫୦ | ପୂର୍ଣ୍ଣାଙ୍ଗ | ୩.୦୧ |

ପ୍ରତିଷ୍ଠାପକ

Annexure - 02

[Signature]
 24.1.14
 Revenue Inspector
 SADAR, ANGUL

[Signature]
 Executive Engineer
 Rural Works Division
 ANGUL

[Signature]
 Secretary
 TAMDA, Angul.

[Signature]
 TALESDAR
 ANGUL

[Signature]
 24.6.14
 Asst. Executive Engineer
 P.H. Sub-Division, Angul

[Signature]
 4.1.14
 Executive Engineer
 R.W. Division, Angul

[Signature]
 Sub-Collector
 Angul.

[Signature]
 Chief District Medical Officer
 (Govt. of Odisha), Angul

[Signature]
 Executive Engineer
 Angul (R.W.) Division.

List of Officials Consulted

OSSRA

Mr. A K Pradhan, Engineer in Chief, Rural Works, Odisha
Mr. S K Sarangi, Chief Engineer II, Rural Works, Odisha
Mr. K Dhal, AE, HQ, Rural Works, Odisha
Mr. M R Tripathy, AE, HQ, Rural Works, Odisha

PIC

Mr. Nasir Ali, Team Ledaer, PIC
Mr.A K Mahapatra, Coordinator, PIC

V. RURAL CONNECTIVITY INVESTMENT PROGRAM– PROJECT 3: WEST BENGAL SOCIAL SAFEGUARDS COMPLIANCE – RRNMUs and RCTRC

A. Context and Purpose of the Report

1. The Government of India (GOI) launched “The Pradhan Mantri Gram Sadak Yojna (PMGSY) in 2000, with the objective to provide all-weather road connectivity to all rural habitations with a population of more than 500 persons in plains and 250 persons in hill states. This program is being implemented through the National Rural Road Development Authority (NRRDA) under the Ministry of Rural Development (MORD) at central level and through the State Rural Road Development Authority/Agencies (SRRDA) at state level.

2. The Rural Connectivity Investment Program (RCIP) supports PMGSY through a multi-Project Financing Facility (MFF) that will construct or upgrade to all-weather standards 3,998 rural roads equivalent to 13,884 km, and connecting 5,238 habitations in the states of Assam, Chhattisgarh, Odisha, Madhya Pradesh and West Bengal (RCIP states). Investments in rural roads will improve connectivity, cut transport costs, and provide enabling infrastructure to areas currently with poor access to markets and urban towns, and thus contribute to growth and equity in the country’s largest sector.

3. RCIP is divided into three separate projects. Project 1 and Project 2 of US\$252 million, and \$US 275 million respectively, were approved in 2013 and are ongoing. Project 3 is expected to be approved at the end of 2015 with an estimated cost of USD 518.30 million.

4. Under RCIP Project 1 (Loan 2881-IND), each State is to establish one pilot RRNMU. Later during RCIP Project 3 (Tranche 3) approximately five additional RRNMUs (30 RRNMUs in total) are planned to be created. The RRNMUs shall be created based on the existing PIUs for rural roads and shall have staffing, equipment, and facilities adequate to provide effective management of the rural road network. The States shall ensure full RRNMU staffing and budget adequate for the full implementation of RRNMU tasks. The States shall prepare the design of RRNMU facilities. Similarly, under RCIP Project 1 (Loan 2881-IND) each State is to establish one RCTRC with the main objective to (i) conduct systematic training of engineers involved in the management of the rural road network, technicians, site supervisors, concerned staff of Panchayati Raj institutions, design consultants and contractors, and (ii) support a sustainable practice-oriented research on rural roads. The RCTRCs shall have staffing, equipment, and facilities adequate to provide high-quality and large scale training, both in house and with the use of external resource persons. Each State shall ensure full RCTRC staffing and budget adequate for the full implementation of RCTRC tasks. Like the RRNMUs, the States shall prepare the design of RCTRC facilities. The West Bengal State Rural Development Agency (WBSRDA) is the implementing agency (IA) for the ADB funded subprojects in the state.

5. The Government is now planning to submit to ADB the third Periodic Finance Request (PFR) covering state of West Bengal. This report has been prepared to serve the purpose for compliance with ADB's social safeguards on involuntary resettlement and indigenous peoples during preparation of the RRNMUs and RCTRC subprojects in the state of West Bengal.

B. Status of RRNMUs and RCTRC in West Bengal

6. The proposed location of the pilot RRNMU is at Barasat in North 24 Pargana district and the RCTRC is proposed to be located at Kalyani in Nadia district near the existing SIRD (Binoy Bhawan). The RCTRC building is proposed in land belonging to Panchayat and Rural Development Department, Govt. of West Bengal, parent department of WBSRDA. The

process of land transfer to Panchayat and Rural Development Department was in progress for the RRNMU site at Barasat.

7. The proposed area under the two units are as under:

- **RCTRC:** The total land area is approximately 1.8 Acres (0.728 Ha). The total built-up area required is 2,156.45 sqm.
- **Pilot RRNMU:** The total land area is approximately 688.0 Sqm and the total built-up area is 1,210.00 Sqm.

C. Social Safeguards in the Project

8. The RCTRC building is proposed in land owned by Panchayat and Rural Development Department (PRDD), Govt. of West Bengal (GoWB) and the land for the pilot RRNMU is in the process of transfer to PRDD, GoWB. Locations of additional RRNMUs are yet to be finalized. To mitigate the possible adverse impacts of the subprojects, the community participation framework (CPF) lists various types of impact categories and mitigation measures which would apply to the subprojects, based on the specific project impacts.

Mitigation Measures Matrix

| Impact Category | Mitigation Measures | Responsibility |
|----------------------------------|--|-------------------------------------|
| Loss of Agricultural Land | <ul style="list-style-type: none"> • Willing transfer of land by means of MOU • Advance notice to harvest standing crops • For vulnerable affected persons (APs), assistance/support by means of (a) alternate land sites provided by GP, or (b) cash assistance as per replacement cost¹⁷ by the Gram Panchayat (GP) to meet loss of land; and inclusion as beneficiaries in the existing poverty alleviation/livelihood restoration programs (see Annex of relevant state Community Participation Framework) • For land involving traditional and tenurial rights, the legal provisions applicable of the central and state governments pertaining to transfer of land will be followed. Existing customary rights of the tribal communities on various categories of land shall be taken into account during the process of land transfer. | GP, PIU and land revenue department |
| Loss of Structure | <ul style="list-style-type: none"> • Provision of alternate plot of land and structure of equivalent quality and value to be provided as per AP's choice, or cash assistance by GP to meet the loss of land and structure allowing the AP to purchase land & rebuild structure of equivalent standard • For loss of boundary walls and fences, willing transfer by means of MOU. In case voluntary donation of such structures are not possible, cash assistance as per replacement cost by GP to meet loss of such structures, or provision of materials and/or labor by GP to allow the AP to replace/rebuild the same • For vulnerable APs, inclusion as beneficiaries in the rural development (RD) programs/housing schemes (see Annex of relevant state Community Participation Framework) | GP, PIU and land revenue department |

¹⁷Replacement cost means the "cost" to replace the lost asset at current market value or its nearest equivalent, plus any transaction costs such as administrative charges, taxes, registration and titling costs allowing the individual / community to replace what is lost and their economic and social circumstances to be at least restored to the pre-project level.

| Impact Category | Mitigation Measures | Responsibility |
|--|---|-------------------------------------|
| Loss of Structure (Contd.) | <ul style="list-style-type: none"> For tenants, assistance to find alternative rental arrangements by GP, or cash assistance equivalent to advance payments made to the owner For squatters, provision of alternative relocation site, or cash assistance as per replacement cost, or provision of building material and/or labor by GP, or inclusion as beneficiaries in the RD programs/housing schemes. For land and structure involving traditional and tenurial rights, the legal provisions applicable of the central and state governments pertaining to transfer of land will be followed. Existing customary rights of the tribal communities on various categories of land shall be taken into account during the process of land transfer. | GP, PIU and land revenue department |
| Loss of livelihood | <ul style="list-style-type: none"> For vulnerable APs, inclusion as beneficiaries in the existing poverty alleviation /livelihood restoration programs (enumerated in Annex 9). In case of non inclusion in such programs, cash assistance to meet the loss of income during transitional phase and for income restoration. Assistance for asset creation¹⁸ by community and Gram Panchayat. | GP and PIU |
| Loss of Assets such as Trees, Well, and Ponds | <ul style="list-style-type: none"> Willing transfer of the asset by means of MOU. For vulnerable APs, assistance for the loss of these assets through inclusion as beneficiaries in the existing poverty alleviation/livelihood restoration programs (enumerated in Annex 9). In case of non inclusion in such programs, cash assistance by GP to meet the loss of assets and income. | GP, PIU and land revenue department |
| Loss of community owned assets such as temple, wells, ponds, grazing land etc | <ul style="list-style-type: none"> Relocation or construction of asset by GP with technical inputs from PIU Consultations with the concerned section of the community in case of grazing land, etc | GP, PIU and land revenue department |
| Temporary impacts during construction | <ul style="list-style-type: none"> Civil works contract conditions to include provisions to obligate the contractor to implement appropriate mitigation measures for the temporary impacts include disruption of normal traffic, increased noise levels, dust generation, and damage to adjacent parcel of land due to movement of heavy machinery to be included the Civil Works Contract | PIU |
| Other impacts not identified | Unforeseen impacts will be documented and mitigated based on the principles in this Framework. | |

D. Approach and Methodology for Assessing Social Safeguards Compliance during preparation of the subprojects

9. The consultants visited both the sites for RCTRC building at Kalyani and the pilot RRNMU site at Barasat and carried out consultations with the officials of WBSRDA, PIU North 24 Parganas and the project architect. Both the sites are vacant and free from any

¹⁸ Assistance for asset creation shall comprise of assistance for creation of cattle shed, shop, production unit or any other form of income generating asset that will enable the affected household in restoring their livelihood.

encumbrances. They also carried out a desk review of the documents prepared for the project design, tender documents and the departmental orders for locating the proposed centres at the designated locations.

10. The SRRDA with assistance from PIC conducted social safeguard screening of the proposed sites for the RCTRC and RRNMU. For the screening purpose a Social Safeguards Checklist was adopted that is presented in the appendices. As both the RCTRC and pilot RRNMU buildings are proposed in land owned and under possession of Deptt. of Panchayat and Rural Development, Govt. of Chhattisgarh; the parent department of CGRRRDA, there will be no need for monitoring of adverse impacts due to land requirement. However, PIC will provide monitoring support to the SRRDA for issues might arise during execution of the project.



Site for RCTRC - Kalyani



Site for RRNMU – Barasat

E. Findings

1. Land Ownership

11. PRDD, GoWB, parent department of WBSRDA is the owner of the land for the proposed RCTRC at Kalyani, while the land for the pilot RRNMU at Barasat is under the process of land transfer.

2. Current Land use

a. Site for the Proposed RCTRC at Kalyani

12. The RCTRC is proposed adjacent to the existing SIRD (Binoy Bhawan) at Kalyani. The proposed RCTRC will have a two storied academic block, a two storied hostel block, a guest house block and the Director's residence. The site is vacant without any encroachment. It has 4 trees within the plot of which only 1 will be affected. There are no structures or other hindrances. The land is owned by Panchayat and Rural Development Department (PRDD), Govt. of West Bengal (GoWB).



b. Site for the Pilot RRNMU Building at Barasat

13. RRNMU is proposed at Barasat near the railway station. The site is also close to the court complex and the bus stand. The land is vacant and is in possession of Panchayat and Rural Development Department, Government of West Bengal. The process of transferring the land to WBSRDA is ongoing. The proposed site is more or less rectangular and will have a ground plus three storied structure. The site has clear approach from the road connecting to bus stand and court complex side and within a km from the PIU office.



3. Types of Loss and Affected Persons

14. The land parcels proposed for various activities under RCTRC and the pilot RRNMU are vacant plots without any structure and encroachment. However, both the plots are not fenced or have boundary walls on all sides.

4. Consultation with Affected Persons

15. Consultants had consultations with senior officers of WBSRDA, PIU, North 24 Parganas and the project architect (list attached in appendices). WBSRDA has already obtained required municipal approvals for the RCTRC buildings at Kalyani. PIU, North 24 Parganas has already applied for the municipal approvals for the RRNMU at Barasat and the same is under process.



Consultation at RCTRC Site



Consultation at RRNMU Site

5. Institutional Arrangements and Grievance Redress Mechanism

16. WBSRDA is the Implementing Agency. The land for both the RCTRC and RRNMU site belong to Panchayat and Rural Development Deptt., Govt. of West Bengal; the parent department of WBSRDA. There is no encroachment in any of the two sites. Government departmental procedures are in place to address any grievances that might arise. The recruitment of the PIC is in process and they will assist WBSRDA in addressing the safeguard issues in the project and monitoring of the related aspects.

F. Conclusion

17. The site visit and review of social assessment checklist prepared for the RCTRC and pilot RRNMU sites revealed that:

- a. Land is owned and in possession of Panchayat and Rural Development Deptt., Govt. of West Bengal; the parent department of WBSRDA. While land for the RCTRC site has been already transferred to WBSRDA, the same is in process for the RRNMU site at Barasat.
- b. Both the plots proposed for RCTRC and pilot RRNMU are vacant and free from encroachment.
- c. There was consultation with senior officers of WBSRDA, PIU, North 24 Parganas and the project architect. Required municipal approvals have been already obtained for the RCTRC site while the same is under process at Barat Municipality.
- d. SRDA has departmental procedure in place to address any grievance that might arise. Recruitment of PIC is in the and they will assist WBSRDA in monitoring of safeguard issues.

Appendix 1: Social Safeguards Checklist for RCTRC at Kalyani, West Bengal

1. Where is the RCTRC located?

The site of proposed RCTRC at Kalyani is approximately 55 Km from North Kolkata connected by Kalyani Expressway. Kalyani is a planned township. The surrounding roads are fairly wide and is in good condition

2. What are the land requirements of the building (area size requirements)?

The total land area is approximately 1.8 Acres (0.728 Ha). The total built-up area required is 2,156.45 sqm.

3. What is the current land use of this area?

The land is vacant and is in Government Possession.

4. Does some/all the land belong to the SRRDA? If all the land does, please provide documentation in annex and skip to question # 7

All land is in possession of Government Panchayat and Rural Development, Government of West Bengal.

5. If the land does not belong to the SRRDA, is it government land? If yes, please describe share of land and size area belonging to government as well as procedures for SRRDA to acquire the government land.

Land belongs to Panchayat and Rural Development Deptt., Government of West Bengal the parent department of WBSRRDA.

6. Is some of the land private land? If yes describe the share and size of private land required and provide short brief census¹⁹of affected households and survey of affected assets

Not Applicable since no private land is to be acquired whatsoever

7. If the land is SRRDA's or belong to another public entity, are there any structures, agricultural activities belonging/conducted by squatters on the plot? If yes, please conduct brief census of affected households and survey of affected assets

The land is vacant.

8. If answers to questions 6 and 7 are yes, please indicate mitigation measures as per the Mitigation Measure Matrix (Table 5.1 p. 2) of each state's Community Participation Framework (CPF). If any land/structures are donated, please describe participatory approach and provide substantiating documentation in annexes.

¹⁹Census should follow similar format as the one conducted for the Community Participation Framework

In RCTRC at Kalyani no mitigation measures are required as no individual or group is affected by the project.

9. Additional comment (if any):

None

Existing Site Condition – Proposed RCTRC at Kalyani



Layout Plan for RCTRC Site

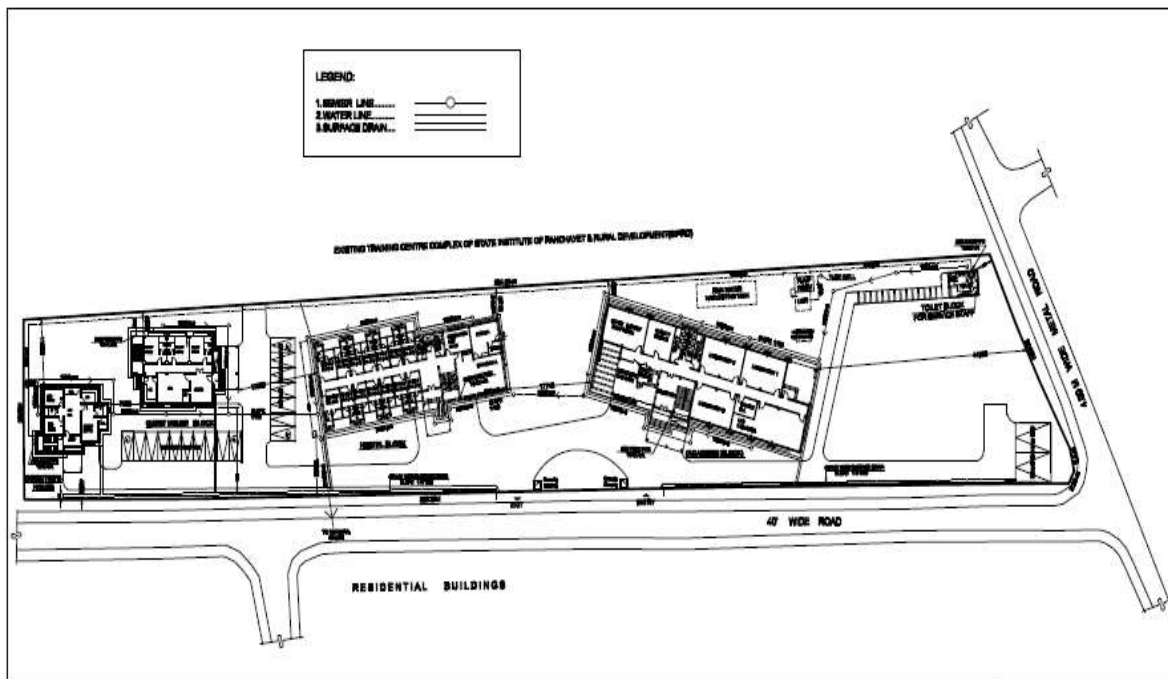
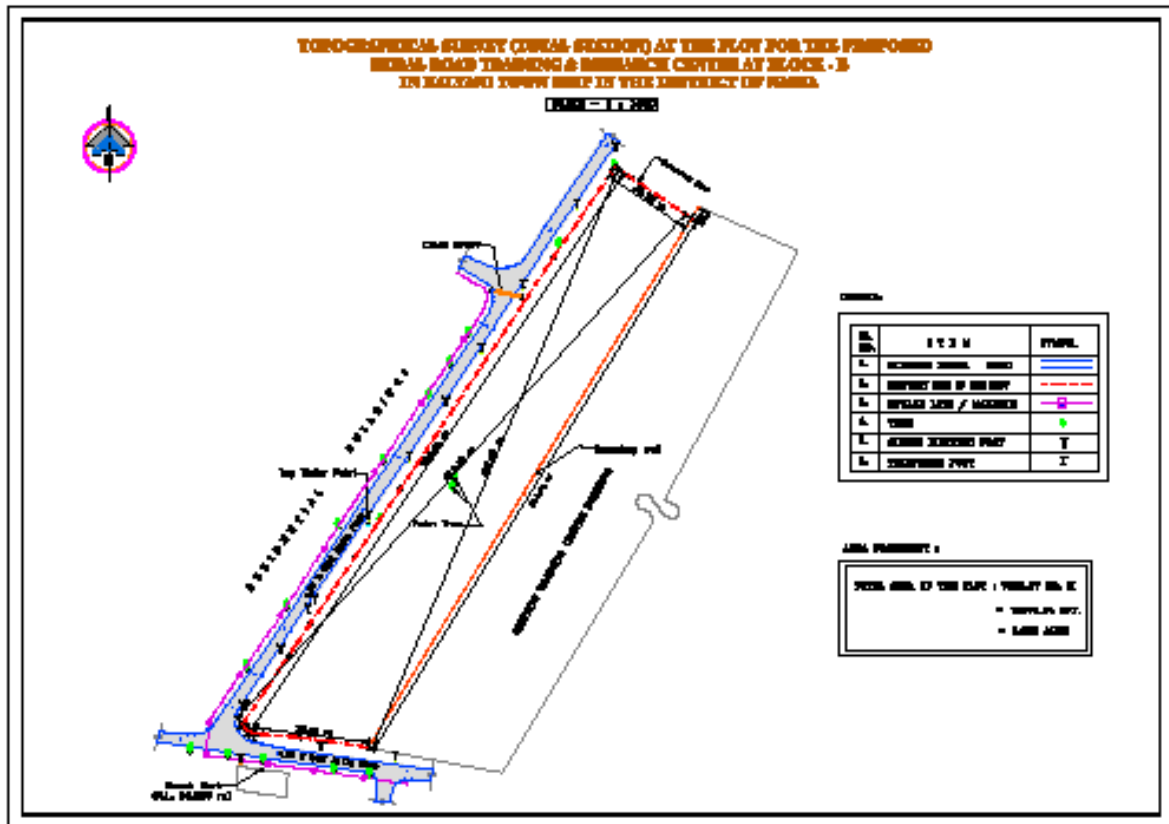

Appendix 2: Social Safeguards Checklist for Pilot RRNMU at Barasat, West Bengal

1. Where is the RRNMU located?

The site of Proposed RRNMU at Barasat is about 35 Km from north of Kolkata and is near Barasat Railway Station

2. What are the land requirements of the building (area size requirements)?

The total land area is approximately 688.0 Sqm and the total built-up area is 1,210.00 Sqm.

3. What is the current land use of this area?

The land is vacant and is in Government Possession.

4. Does some/all the land belong to the SRRDA? If all the land does, please provide documentation in annex and skip to question # 7

The land is in possession of Panchayat and Rural Development Department, Government of West Bengal.

5. If the land does not belong to the SRRDA, is it government land? If yes, please describe share of land and size area belonging to government as well as procedures for SRRDA to acquire the government land.

Land under possession of Panchayat and Rural Development Deptt., Government of West Bengal the parent department of WBSRRDA.

6. Is some of the land private land? If yes describe the share and size of private land required and provide short brief census²⁰of affected households and survey of affected assets

Not Applicable since no private land is to be acquired whatsoever

7. If the land is SRRDA's or belong to another public entity, are there any structures, agricultural activities belonging/conducted by squatters on the plot? If yes, please conduct brief census of affected households and survey of affected assets

The land is vacant.

8. If answers to questions 6 and 7 are yes, please indicate mitigation measures as per the Mitigation Measure Matrix (Table 5.1 p. 2) of each state's Community Participation Framework (CPF). If any land/structures are donated, please describe participatory approach and provide substantiating documentation in annexes.

Not applicable

9. Additional comment (if any):

None

²⁰Census should follow similar format as the one conducted for the Community Participation Framework

Existing Site Conditions – Proposed Pilot RRNMU Site at Barasat



Layout Plan for Pilot RRNMU Site - Barasat

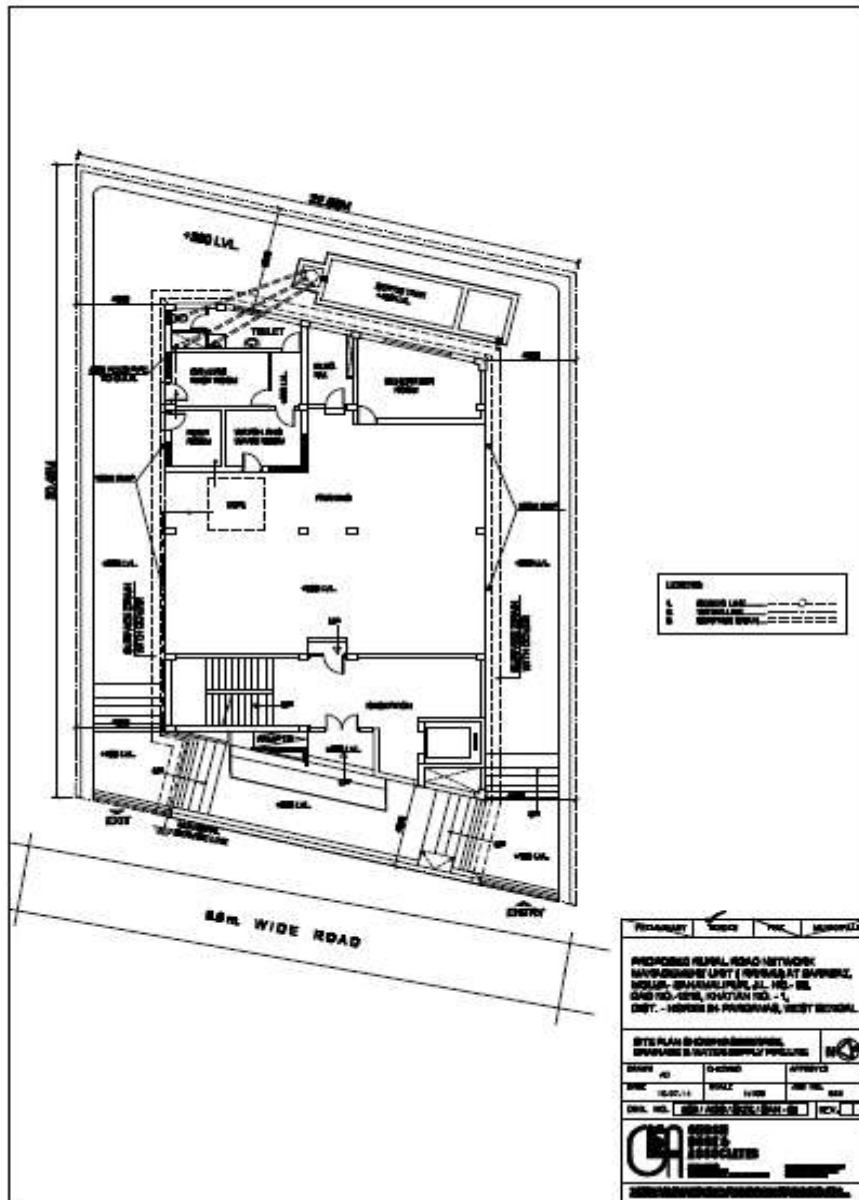
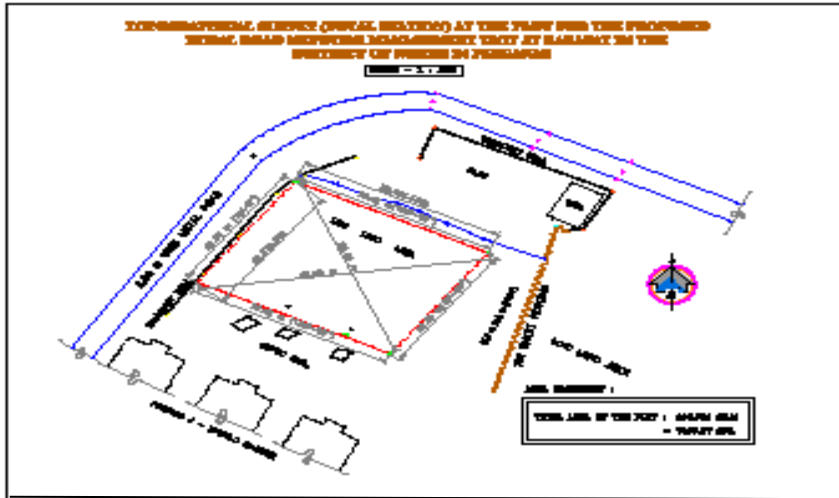

| | | | |
|---|---------------------------|-------|-------------|
| PROJECT | NO. | DATE | APPROVED BY |
| PROPOSED RURAL ROAD NETWORK MAINTENANCE UNIT (RRNMU) AT BARASAT, HOURLY-GRANULATED, 100-100 (S&T) - 1000, 1000 (S&T) - 1, DIST. - 1000 IN PROGRAM, WEST BENGAL. | | | |
| SITE PLAN & CONSTRUCTION DRAWINGS & INTERIM SUPPLY PIPING | | | |
| SCALE | 1:1000 | DATE | APPROVED BY |
| DATE | 10.01.14 | SCALE | 1:1000 |
| DRG. NO. | RRNMU-1000-1000-1000-1000 | REV. | 1/1 |
| | | | |

List of Officials Consulted

Mr. Tapabrata Ghosh, SE, HQ
Mr. Dulal Chandra Ghosh, EE, N 24 Parganas
Mr. Akshay Bhowmick, AE, EE, N 24 Parganas
Mr. Sudip Mukherjee, AE, EE, N 24 Parganas
Mr. Tribeni Prasad Bagchi, Project Architect